



America's premier induction cook range that creates a countertop that you can cook directly on two to five burners. Easily operate through control pad or on wifi through the app.



[Click to Watch on YouTube](#)



ROBERT F. HENRY
TILE COMPANY
EST. 1933

ROBERT F. HENRY TILE IS AN AUTHORIZED INVISACOOK® DEALER.

Cooktops: 2, 3, 4 or 5 Burner



5-Piece Invisacookware®

5-Ply Stainless Steel with Copper Core, for ultimate performance.



InvisaMat

Anti-slip cooking mat



Induction cooktop Mat 100°F

No Induction cooktop Mat 204°F

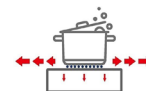

VS



INVISAMAT

Induction & Anti-Slip Cooking Mat



Induction cooktop Mat **100°F**

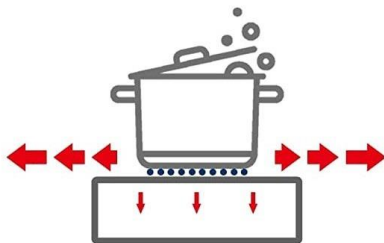

V S

No Induction cooktop Mat **204°F**

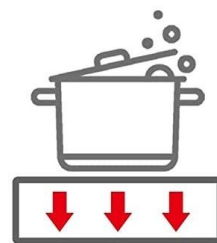

Silicone ridges extends the lifespan of induction cooktops by diffusing the heat which pass from cookware back to the induction stove.

Without the mat heat passes back into the cooktop and builds up inside which significantly lessens the lifespan of induction cooktops

Condition - 16oz of water, 5minutes, P9 (2000W)

Depending on your cooktop and cookware, results may vary.

Heat Diffusing

Raised silicone ridges extend the lifespan of induction cooktops by diffusing the heat during cooking



Safer cooking

Prevents cookware from sliding during cooking

Easier to clean

Ridges contains spills, preventing them from reaching your induction cooktop

Flexible and Durable

Formula of silicone and fiberglass prevents scratches and scrapes from contact with cookware

INVISA  MAT





FAQ's



HOW DO I KNOW WHERE THE BURNERS ARE?

Designed with a noise locator, or a device that beeps that starts when you turn on your unit and audibly designates the burner you want to use. The beeping will stop when your pan connects with the cooktop surface. During installation, ask them to place a sticker there until you have a feeling for where the burner is located.

WHAT SURFACE MATERIALS CAN I USE WITH INVISACOOK®?

We recommend large format porcelain material that is 12mm to 20mm thick. [Robert F. Henry Tile Co. stocks 12mm porcelain in 6 colors, 2 finishes.](#)

DO I NEED TO USE SPECIAL COOKWARE?

There are many induction quality pots and pans on the market, however, the most compatible pans for the Invisacook® are a full clad stainless-steel type of pan, mostly known as Tri-Ply or 5Ply Cookware. Invisacook has its own cookware line too, which is 5Ply, Hex Non-Stick, with risers on them. The Invisamat® is not needed when using our Invisacookware®. Use the Invisamat® when using other types of cookware.

Non-Compatible: Aluminum, all-copper, or glass cookware will not work unless they have a layer on the bottom with magnetic properties. Many manufacturers have started adding a magnetic layer to the bottom of those types of pots and pans; however, it can be very thin and will take longer to heat up than a high-quality induction pan, or it may redirect the residual heat back to the countertop, which may be catastrophic for your new countertop. [Cast Iron is not recommended on most if not all induction units, as they lower the life span of glass units and are very hard to control the heat levels.](#)

IS THERE ANYTHING SPECIAL I NEED TO DO WITH MY INDUCTION COOKWARE FOR IT TO BE USED ON MY COUNTERTOP?

Nothing needs to be done to your cookware, but we provide you an Invisamat® for each burner for the following reasons:

1. Prevent pans from hitting your countertop and making loud noises.
2. Helps prevent any possible scratches and thermal shock.
3. Keeps the metal from your pan from touching your countertop, while helping the countertop stay cooler longer.

CAN I ORDER THIS PRODUCT DIRECTLY AND INSTALL IT MYSELF?

No. The product needs to be installed by a certified dealer. Robert F. Henry Tile Co. is a certified dealer. If we are installing the porcelain countertops, we will install the Invisacook. No. It is not a plug-and-play

type of unit. If there is not a certified dealer in your area, our corporate team will work with you and your fabricator.

DO THE UNITS HAVE SPECIAL ELECTRICAL REQUIREMENTS?

Yes, 220v twist lock receptacle is needed for the 1-2-3-4 burner unit and 110v receptacle for the 1- and 2-burner units. 5 Burners will need to be hardwired. All units are to be plugged in but can be hardwired, if required in your county or country.

IS THERE ANY SPECIAL CLEANING THAT NEEDS TO BE DONE TO THE COUNTERTOP WHERE THE UNIT IS INSTALLED?

Only the proper care recommended by the stone fabricator and countertop manufacturer is needed.

CAN THE UNIT BE USED WIRELESSLY?

Yes. With the Invisacook® App, you can wirelessly use the cooktop from a remote location.

WHY IS IT THAT WHEN I HAVE ONE BURNER AT FULL POWER AND I TURN ON ANOTHER BURNER, MY FIRST BURNER LOWERS ITS NUMBER?

This is the result of the burners' power sharing. With multiple burners on one side, the unit will automatically attempt to work as efficiently as possible with a total combination of 14. That being said, there is no need to worry — your burners are still receiving adequate levels of power in order to maintain efficient cooking temperatures. For example, when frying food, you will only need Level 7 to be used, and both burners can be at 7 and 7 which equals 14.

DOES THE COUNTERTOP SURFACE GET HOT WHEN YOU ARE COOKING?

Yes. The surface will get warmer and warmer over time as you cook, eventually becoming hot to the touch. **NOTE: A Natural or Matte finish will feel cooler to the touch than a polished finish.** For your standard short cooking time, the surface will not get that hot. However, once you have surpassed about 10 minutes' worth of cooking time, the surface will be HOT, and you should exercise caution around the area in use. The unit controller will also initiate the H symbol to let you know the surface may be hot. Please keep in mind that Induction is a very quick heating process, so when frying foods, you only need a Level 6 or 7 on your controller. The Power Boost is only to be used when boiling water. Remember never cook with an empty cooking vessel.



INVISACOOK

The Original 1 Burner Unit

Model Number # 8113-256-001B

DESCRIPTION

INVISACOOK – 1 Burner Unit is a complete, self-contained system. It has 1 induction points to cook thru your porcelain countertop, evenly and sufficiently. While it has a controller, it can also be controlled thru Wi-Fi using your Invisacook Tuya App.



APPLICATIONS

1 Burner unit can be used in these options and materials:

- Typical House Kitchen
- Multi-Family (Apartments)
- Boats / RVs / Airplanes
- Tiny Houses
- Outdoor Kitchens
- Entertaining Islands or Tables
- Cooking Carts
- Materials– Porcelain

FEATURES

- 1 burning unit elements
- Power Boost option for faster speed.
- Wi-Fi capable with the Invisacook App so you can control your unit from anywhere.
- Designed for Undermounting installation for any countertop surface in any way possible.

DEVICE OPERATION

When a compliant receiver such as an induction quality pan is placed on the induction coil, the unit will automatically adjust the charging power, based on the feedback command from the controller. When searching for connection, LED number will blink red, once pan and unit are connected the LED number will stay illuminated. If the pan moves too far in relation to the induction coil, the LED will blink IC and a Beeping noise will follow, indicating an error in connection. If this (or any other error condition) occurs, try resetting the unit by unplugging it and waiting 10 seconds to reconnect, for an automatic reset.

Status	Indicator
Off	No power/inactive
Power on	LED lights on Red Dash
Connected	LED Number stays illuminated
Lost of Connection	LED Blinking IC Red
Noise Alert	Beeping Noise of no Connection
Error condition	A Letter Followed by a Number(H-8)

FOREIGN OBJECT DETECTION

INVISACOOK – 1 Burner Unit contains an algorithm for sensing the presence of foreign objects placed on the unit. When a foreign object is placed on the transmitter coil during operation, the unit will shut down and the LED will flash red showing IC and make a beeping noise.

INVISACOOK - 1 BURNER UNIT

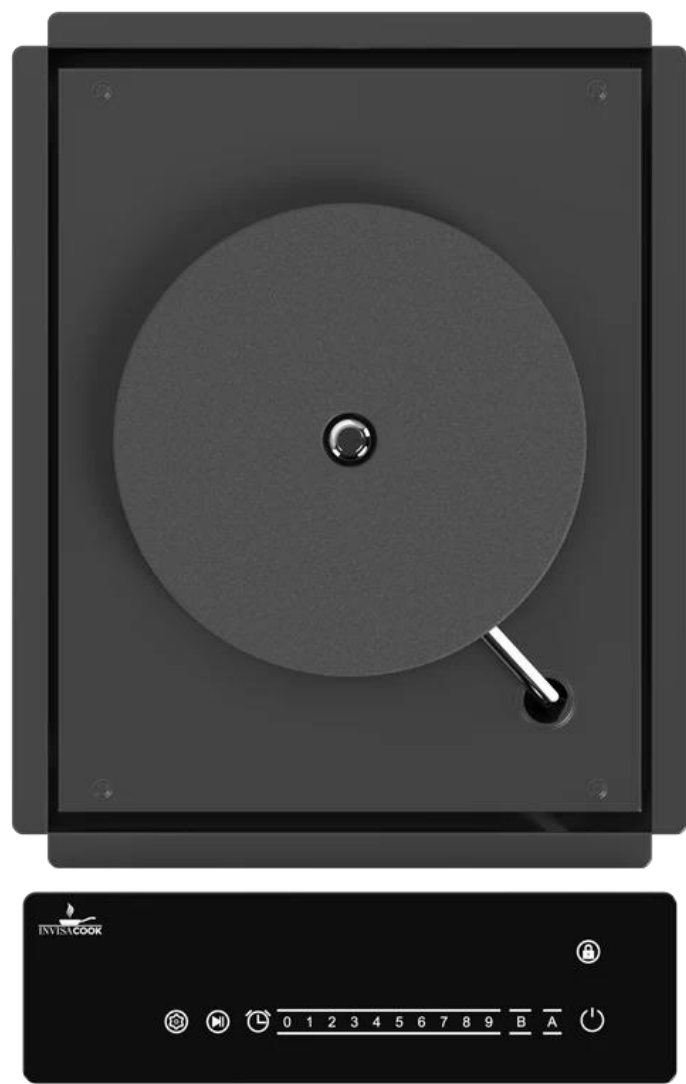

ELECTRICAL ANDMECHANICALSPECIFICATIONS

Dimension	Description
Dimension	375 x 294 x 55mm
Bottom Size	350 x 285 x 49.5mm
Recommended Material	Max thickness is 12mm to 20mm Porcelain
Recommended Breaker	10 AMP Breaker

Connection	Description
AC/DC Input	220/240 Volt - 50/60HZ
Wattage	2000 W
Power	2000w
Platen Burner Size	210mm

TEMPERATURE

Operating Cooking Temps	97°F min / 400 °F max. (36°C min / 205°C max.)
Non-operating Temps	-40°F to 158°F (-40°C to +70°C)

HUMIDITY

Operating:	To85% relative humidity (non-condensing)
Non-Operating:	To95% relative humidity (non-condensing)

ALTITUD

Operating:	to 10,000 feet
Non-operating:	to 50,000 feet

INVISACOOK - 2 BURNER UNIT



WARRANTY

INVISACOOK- 1 Burner Unit – Individual is covered by a 2-year consumer warranty that provides product replacement only and a 3-year extended warranty to be purchased. Please visit Invisacook.com/warranty for more information.

PRODUCT REGULATORY REQUIREMENTS

Intended Application – This product is intended for indoor or outdoor covered use, not for use in inclement weather.

PRODUCT SAFETY

IEC60950-1 (International)

WIFI STANDARDS COMPLIANCE

<https://en.tuya.com>

PRODUCT EMC COMPLIANCE – CLASS B COMPLIANCE

NOTE: The product is required to comply with Class B emission requirements as the end system that it is configured into is intended for a commercial environment and market place. System is to have minimum of 3db margin to Class B Limits.

UL 858 :2014 Ed.16+

EN 55014-1:2017

EN 55014-2:2015+A1:2018

EN 61000-3-2:2019

EN 61000-3-3:2013+A1:2019

CSA C22.2#46:2013 Ed.9

EN 60335-1:2012+A11:2014+A13:2017+A1:2019+A2:2019+A14:2019

EN 60335-2-9:2019

EN 62233:2008

AU/NZ ISO/IEC 17025

G-MARK GLVD0016-0051

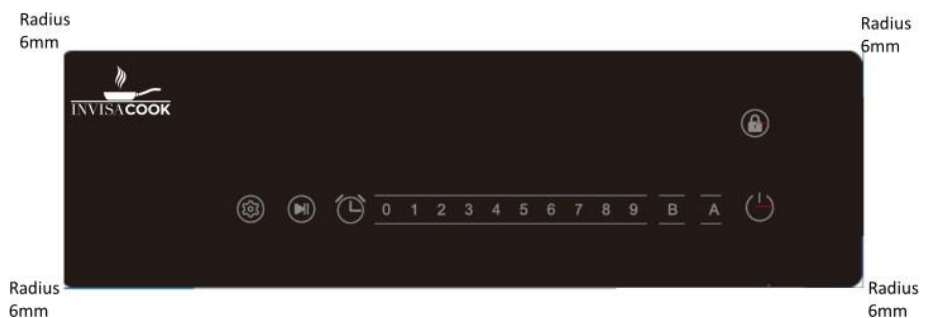

Legal Notices

Information contained in this publication regarding device applications and the like is provided only for your convenience and may be superseded by updates. It is your responsibility to ensure that your application meets with your specifications. "Typical" parameters which may be provided in Energy data sheets and/or specifications can and do vary in different applications and actual performance may vary over time. All operating parameters, including "Typicals" must be validated for your application by your technical experts. INVISACOOK MAKES NO REPRESENTATIONS OR WARRANTIES OF ANY KIND, WHETHER EXPRESS OR IMPLIED, WRITTEN OR ORAL, STATUTORY OR OTHERWISE, RELATED TO THE INFORMATION, INCLUDING BUT NOT LIMITED TO ITS CONDITION, QUALITY, PERFORMANCE, MERCHANTABILITY OR FITNESS FOR PURPOSE. Should the Buyer purchase or use INVISACOOK products for any such unintended or unauthorized application, the Buyer shall indemnify and hold INVISACOOK LLC, and its officers, employees, subsidiaries, affiliates, and distributors harmless against all claims, costs, damages, and expenses, and reasonable attorney fees arising out of, directly or indirectly, any claim of personal injury or death associated with such unintended or unauthorized use, even if such claim alleges that INVISACOOK INC, was negligent regarding the design or manufacture of the unit in question or claim. No licenses are conveyed, implicitly or otherwise, under any INVISACOOK LLC intellectual property rights.

Copyright © 2018 – INVISACOOK INC



2 Burner 110V Unit

Model # 8120-256-001B

DESCRIPTION

INVISACOOK – 2 Burner Unit is a complete, self-contained system. It has 2 induction points to cook thru your porcelain countertop, evenly and sufficiently. While it has a controller, it can also be controlled thru Wi-Fi using your Invisacook Tuya App.



FEATURES

- 2 separate burning unit elements
- Power Boost option for faster speed.
- Wi-Fi capable with the Invisacook App so you can control your unit from anywhere.
- Designed for Undermounting installation for any countertop surface in any way possible.

DEVICE OPERATION

When a compliant receiver such as an induction quality pan is placed on the induction coil, the unit will automatically adjust the charging power, based on the feedback command from the controller. When searching for connection, LED number will blink red, once pan and unit are connected the LED number will stay illuminated. If the pan moves too far in relation to the induction coil, the LED will blink IC and a Beeping noise will follow, indicating an error in connection. If this (or any other error condition) occurs, try resetting the unit by unplugging it and waiting 10 seconds to reconnect, for an automatic reset.

Status	Indicator
Off	No power/inactive
Power on	LED lights on Red Dash
Connected	LED Number stays illuminated
Lost of Connection	LED Blinking IC Red
Noise Alert	Beeping Noise of no Connection
Error condition	A Letter Followed by a Number (H-8)

APPLICATIONS

2 Burner unit can be used in these options and materials:

- Typical House Kitchen
- Multi-Family (Apartments)
- Boats / RVs / Airplanes
- Tiny Houses
- Outdoor Kitchens
- Entertaining Islands or Tables
- Cooking Carts
- Materials– Porcelain

FOREIGN OBJECT DETECTION

INVISACOOK – 2 Burner Unit contains an algorithm for sensing the presence of foreign objects placed on the unit. When a foreign object is placed on the transmitter coil during operation, the unit will shut down and the LED will flash red showing IC and make a beeping noise.

INVISACOOK - 2 BURNER UNIT

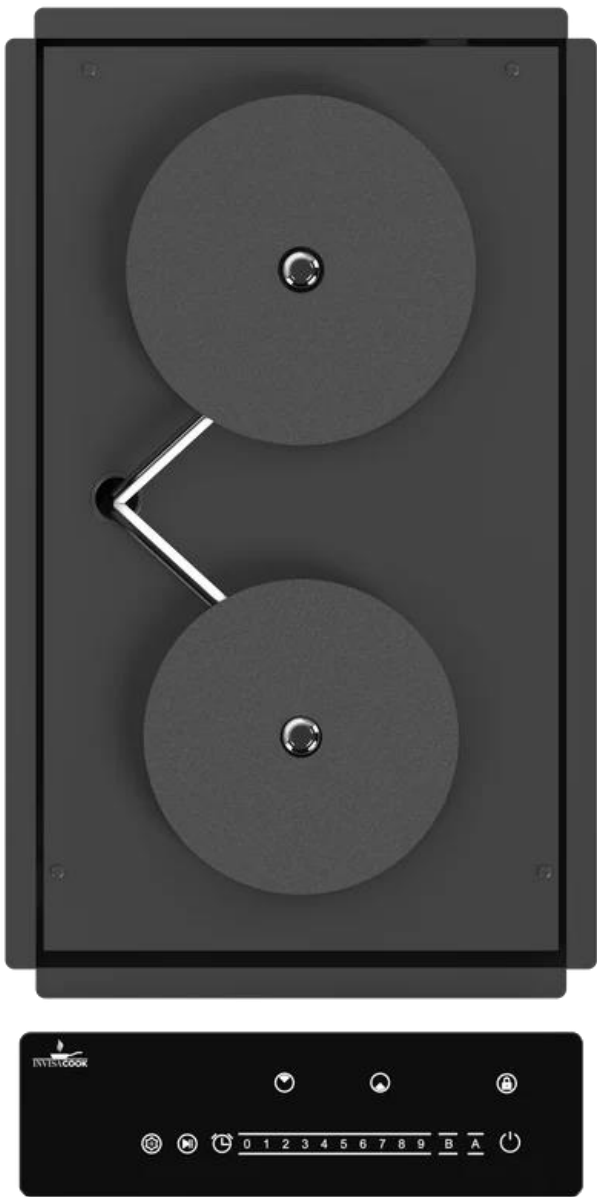

ELECTRICAL ANDMECHANICALSPECIFICATIONS

Dimension	Description
Dimension	510 x 305 x 50mm
Bottom Size	480 x 275 x 49.5mm
Recommended material	Max thickness is 1.5cm porcelain

TEMPERATURE

Operating Cooking Temps	97°F min /400 °F max. (36°C min / 205°C max.)
Non-operating Temps	-40°F to 158°F (-40°C to +70°C)

HUMIDITY

Operating:	To85% relative humidity (non-condensing)
Non-Operating:	To95% relative humidity (non-condensing)

ALTITUDE

Operating:	to 10,000 feet
Non-operating:	to 50,000 feet

Connection	Description
AC Input	110/120 V
Wattage	1,800 W (Total Power Shared) - 8 AMPS
Power Platen Burner.Size	1400w + 1200w (Up+Down) 210mm + 180mm

INVISACOOK - 2 BURNER UNIT



WARRANTY

INVISACOOK– 2 Burner Unit– Individual is covered by a two-year consumer warranty that provides product replacement only and a 3-year limited warranty extension. Please visit [Invisacook.com/warranty](https://en.invisacook.com/warranty) for more information.

PRODUCT REGULATORY REQUIREMENTS

Intended Application – This product is intended for indoor or outdoor covered use, not for use in inclement weather.

PRODUCT SAFETY

IEC 60950-1 (International)

WIFI STANDARDS COMPLIANCE

<https://en.tuya.com/>

PRODUCT EMC COMPLIANCE – CLASS B COMPLIANCE

NOTE: The product is required to comply with Class B emission requirements as the end system that it is configured into is intended for a commercial environment and market place. System is to have minimum of 3db margin to Class B Limits. UL 858 :2014 Ed.16+

EN 55014-1:2017

EN 55014-2:2015+A1:2018

EN 61000-3-2:2019

EN 61000-3-3:2013+A1:2019

CSA C22.2#46:2013 Ed.9

EN 60335-1:2012+A11:2014+A13:2017+A1:2019+A2:2019+A14:2019

EN 60335-2-9:2019

EN 62233:2008

AU/NZ ISO/IEC 17025

G-MARK GLVD0016-0051

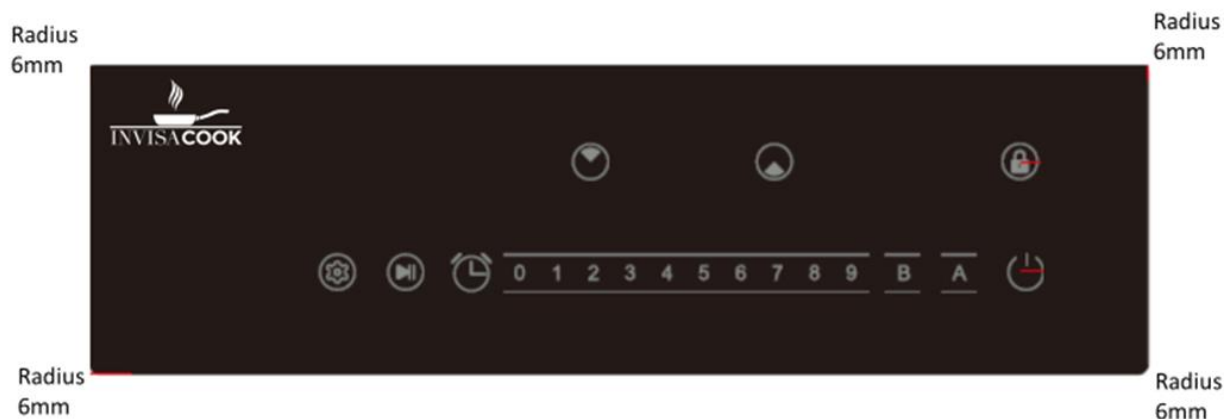

Legal Notices

Information contained in this publication regarding device applications and the like is provided only for your convenience and may be superseded by updates. It is your responsibility to ensure that your application meets with your specifications. "Typical" parameters which may be provided in Energy data sheets and/or specifications can and do vary in different applications and actual performance may vary over time. All operating parameters, including "Typicals" must be validated for your application by your technical experts. INVISACOOK MAKES NO REPRESENTATIONS OR WARRANTIES OF ANY KIND, WHETHER EXPRESS OR IMPLIED, WRITTEN OR ORAL, STATUTORY OR OTHERWISE, RELATED TO THE INFORMATION, INCLUDING BUT NOT LIMITED TO ITS CONDITION, QUALITY, PERFORMANCE, MERCHANTABILITY OR FITNESS FOR PURPOSE. Should the Buyer purchase or use INVISACOOK products for any such unintended or unauthorized application, the Buyer shall indemnify and hold INVISACOOK LLC, and its officers, employees, subsidiaries, affiliates, and distributors harmless against all claims, costs, damages, and expenses, and reasonable attorney fees arising out of, directly or indirectly, any claim of personal injury or death associated with such unintended or unauthorized use, even if such claim alleges that INVISACOOK LLC et al, was negligent regarding the design or manufacture of the unit in question or claim. No licenses are conveyed, implicitly or otherwise, under any INVISACOOK LLC intellectual property rights.

Copyright © 2018 – INVISACOOK LLC

INVISACOOK - 2 BURNER UNIT

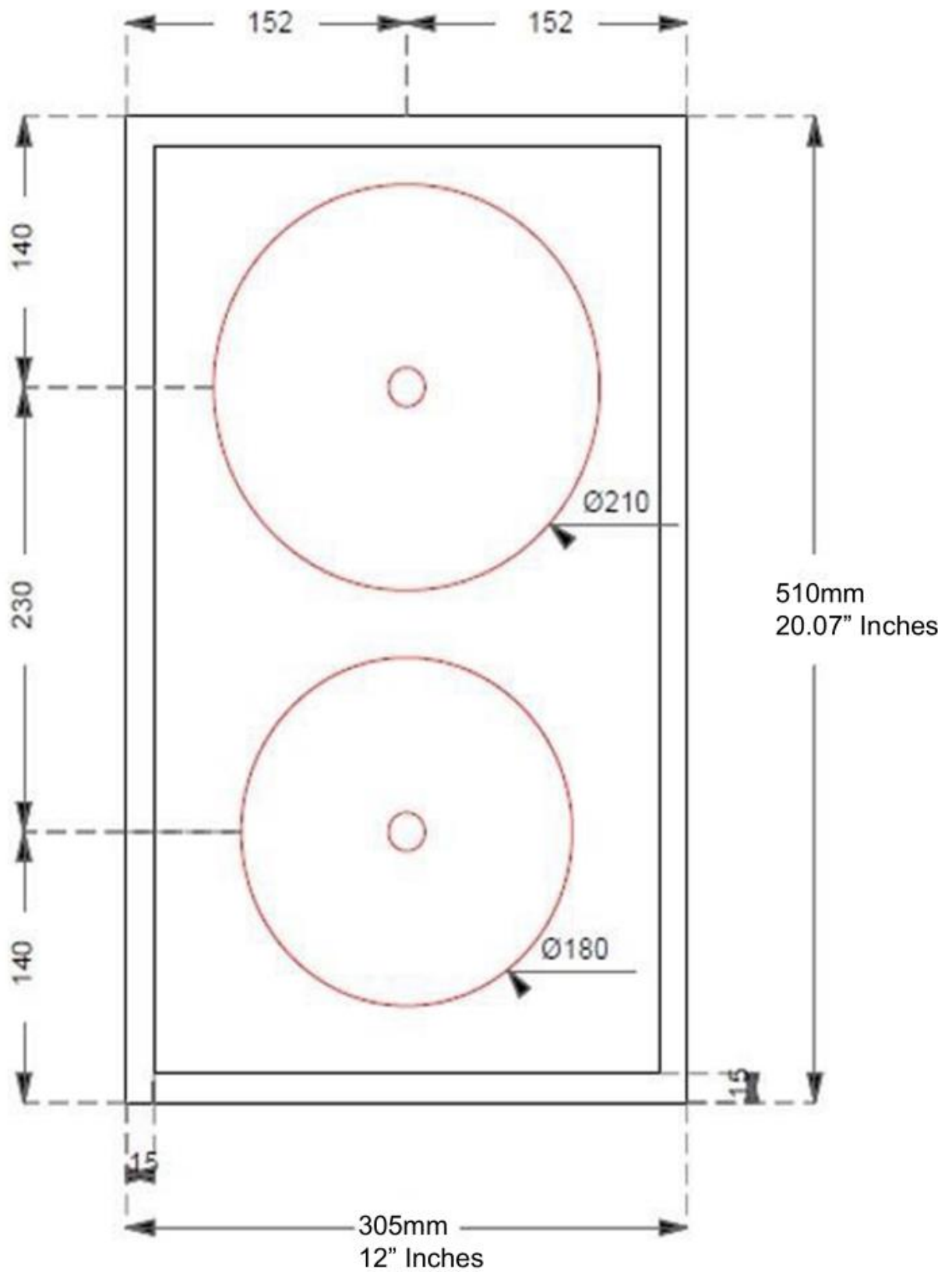



3 Burner 220V Unit

Model Number # 8134-256-001B

DESCRIPTION

INVISACOOK – 3 Burner Unit is a complete, self-contained system. It has 3 induction points to cook thru your porcelain countertop, evenly and sufficiently. While it has a controller that can be placed anywhere.



FEATURES

- 3 separate burning unit elements
- Power Boost option for faster Water Boiling speed.
- Designed for Undermounting installation for any Porcelain countertop surface in any way possible

DEVICE OPERATION

When a compliant receiver such as an induction quality pan is placed on the induction coil, the unit will automatically adjust the charging power, based on the feedback command from the controller. When searching for connection, LED number will blink red, once pan and unit are connected the LED number will stay illuminated. If the pan moves too far in relation to the induction coil, the LED will blink IC and a Beeping noise will follow, indicating an error in connection. If this (or any other error condition) occurs, try resetting the unit by unplugging it and waiting 10 seconds to reconnect, for an automatic reset.

APPLICATIONS

3 Burner unit can be used in these options and materials:

- Typical House Kitchen
- Multi-Family (Apartments)
- Boats / RVs / Airplanes
- Tiny Houses
- Outdoor Kitchens
- Entertaining Islands or Tables
- Cooking Carts
- **Materials** – Porcelain

Status	Indicator
Off	No power/inactive
Power on	LED lights on Red Dash
Connected	LED Number stays illuminated
Lost of Connection	LED Blinking IC Red
Noise Alert	Beeping Noise of no Connection
Error condition	A Letter Followed by a Number (H-8)

FOREIGN OBJECT DETECTION

INVISACOOK – 3 Burner Unit - Unit contains an algorithm for sensing the presence of foreign objects placed on the unit. When a foreign object is placed on the transmitter coil during operation, the unit will shut down and the LED will flash red showing IC and make a beeping noise.

INVISACOOK - 3 BURNER UNIT



ELECTRICAL AND MECHANICAL SPECIFICATIONS

Dimension	Description
Dimension	770 x 400 x 50mm
Bottom Size	750 x 370 x 49.5mm
Recommended material	Max thickness is 20mm to 12mm porcelain

Connection	Description
AC Input	220-240Vac 50/60HZ
Wattage	4,600 W (Total Shared) 21 AMPs
Power Platen Burner Size	2000w + 1600w + 2000w 210mm – 180mm – 210mm

TEMPERATURE

Operating Cooking Temps	97°F min / 400 °F max. (36°C min / 205°C max.)
Non-operating Temps	-40°F to 158°F (-40°C to +70°C)

HUMIDITY

Operating:	To 85% relative humidity (non-condensing)
Non-Operating:	To 95% relative humidity (non-condensing)

ALTITUDE

Operating:	to 3,048 Meters
Non-operating:	to 15,240 Meters

INVISACOOK - 3 BURNER UNIT



WARRANTY

INVISACOOK – 3 Burner Unit – Individual is covered by a two-year consumer warranty that provides product replacement only and a five-year limited warranty.

PRODUCT REGULATORY REQUIREMENTS

Intended Application – This product is intended for indoor or outdoor covered use, not for use in inclement weather.

PRODUCT SAFETY

IEC60950-1 (International)

PRODUCT EMC COMPLIANCE – CLASS B COMPLIANCE

NOTE: The product is required to comply with Class B emission requirements as the end system that it is configured into is intended for a commercial environment and market place. System is to have minimum of 3db margin to Class B Limits.

UL 858 :2014 Ed.16+

EN 55014-1:2017

EN 55014-2:2015+A1:2018

EN 61000-3-2:2019

EN 61000-3-3:2013+A1:2019

CSA C22.2#46:2013 Ed.9

EN 60335-1:2012+A11:2014+A13:2017+A1:2019

+A2:2019+A14:2019

EN 60335-2-9:2019

EN 62233:2008

AU/NZ ISO/IEC 17025

G-MARK GLVD0016-0051

TUV (EU) No 66/2014 – 2009/125/EC



Legal Notices

Information contained in this publication regarding device applications and the like is provided only for your convenience and may be superseded by updates. It is your responsibility to ensure that your application meets with your specifications. "Typical" parameters which may be provided in Energy data sheets and/or specifications can and do vary in different applications and actual performance may vary over time. All operating parameters, including "Typicals" must be validated for your application by your technical experts. INVISACOOK MAKES NO REPRESENTATION OR WARRANTIES OF ANY KIND, WHETHER EXPRESS OR IMPLIED, WRITTEN OR ORAL, STATUTORY OR OTHERWISE, RELATED TO THE INFORMATION, INCLUDING BUT NOT LIMITED TO ITS CONDITION, QUALITY, PERFORMANCE, MERCHANTABILITY OR FITNESS FOR PURPOSE. Should the Buyer purchase or use INVISACOOK products for any such unintended or unauthorized application, the Buyer shall indemnify and hold INVISACOOK LLC, and its officers, employees, subsidiaries, affiliates, and distributors harmless against all claims, costs, damages, and expenses, and reasonable attorney fees arising out of, directly or indirectly, any claim of personal injury or death associated with such unintended or unauthorized use, even if such claim alleges that INVISACOOK LLC et al, was negligent regarding the design or manufacture of the unit in question or claim. No licenses are conveyed, implicitly or otherwise, under any INVISACOOK LLC intellectual property rights.

Copyright © 2018 – INVISACOOK INC

INVISACOOK - 3 BURNER UNIT

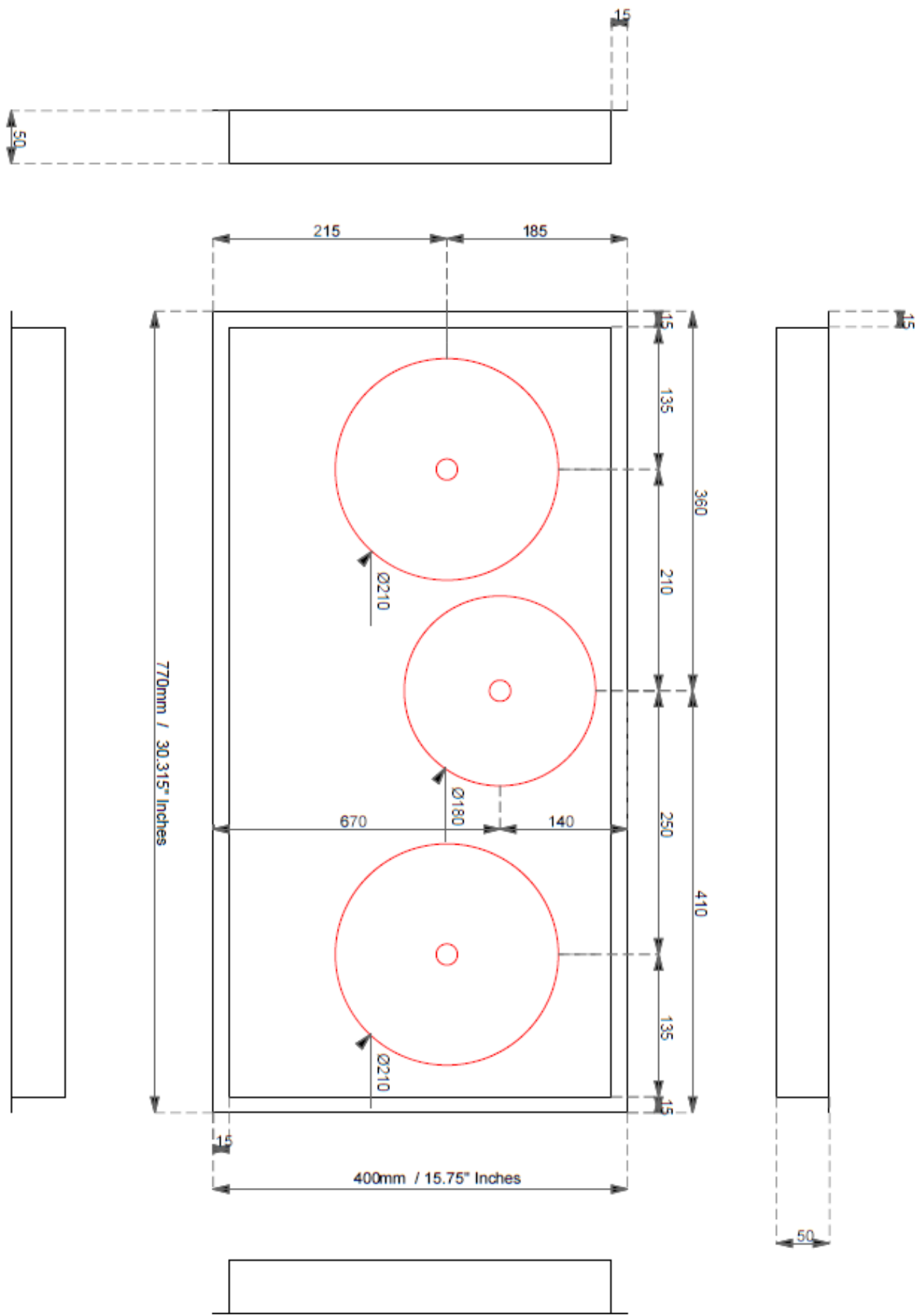



4 Burner 220V Unit

Model # 8140-257-001B

DESCRIPTION

INVISACOOK – 4 Burner Unit is a complete, self-contained system. It has 4 induction points to cook thru your Porcelain countertop, evenly and sufficiently. While it has a controller that can placed anywhere



FEATURES

- 4 separate burning unit elements
- Power Boost option for faster Water Boiling speed.
- Designed for Undermounting installation for any Porcelain countertop surface in any way possible

DEVICE OPERATION

When a compliant receiver such as an induction quality pan is placed on the induction coil, the unit will automatically adjust the charging power, based on the feedback command from the controller. When searching for connection, LED number will blink red, once pan and unit are connected the LED number will stay illuminated. If the pan moves too far in relation to the induction coil, the LED will blink IC and a Beeping noise will follow, indicating an error in connection. If this (or any other error condition) occurs, try resetting the unit by unplugging it and waiting 10 seconds to reconnect, for an automatic reset.

APPLICATIONS

4 Burner unit can be used in these options and materials:

- Typical House Kitchen
- Multi-Family (Apartments)
- Boats / RVs / Airplanes
- Tiny Houses
- Outdoor Kitchens
- Entertaining Islands or Tables
- Cooking Carts
- **Materials**– Porcelain

Status	Indicator
Off	No power/inactive
Power on	LED lights on Red Dash
Connected	LED Number stays illuminated
Lost of Connection	LED Blinking IC Red
Noise Alert	Beeping Noise of no Connection
Error condition	A Letter Followed by a Number (H-8)

FOREIGN OBJECT DETECTION

INVISACOOK – 4 Burner Unit- Unit contains an algorithm for sensing the presence of foreign objects placed on the unit. When a foreign object is placed on the transmitter coil during operation, the unit will shut down and the LED will flash red showing IC and make a beeping noise.

INVISACOOK - 4 BURNER UNIT

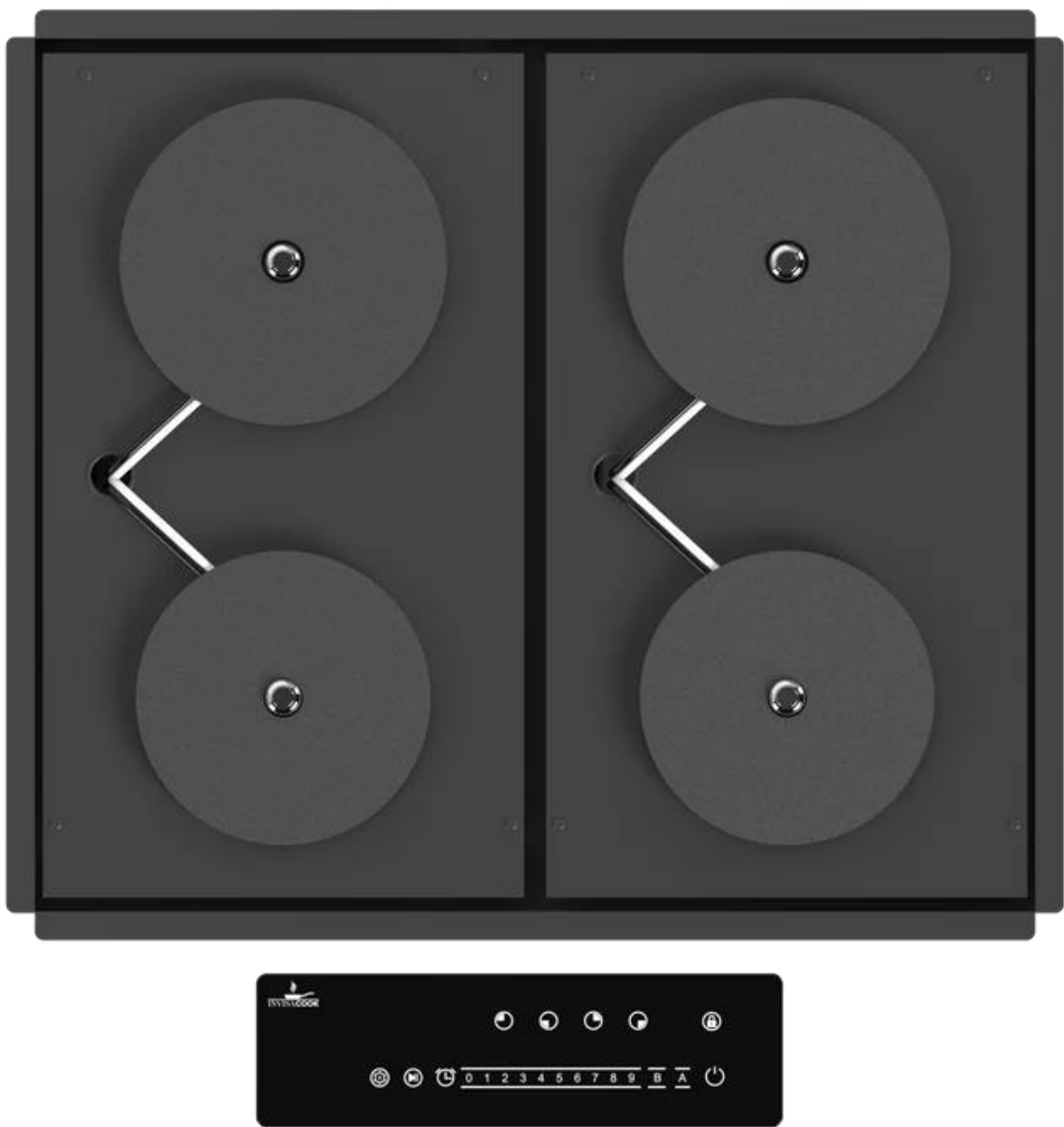

ELECTRICAL ANDMECHANICALSPECIFICATIONS

Dimension	Description
Dimension	582 x 512 x 50mm
Bottom Size	552 x 482 x 49.5mm
Recommended material	Max thickness is 20mm to 12mm Porcelain.

Connection	Description
AC Input	220/240Vac 50/60HZ
Wattage	5,200 W (Total Shared) 23.6 AMPs
Power Platen Burner Size	2000w + 1600w + 2000w + 1600w 210mm - 180mm - 210mm - 180mm

TEMPERATURE

Operating Cooking Temps	97°F min /400 °F max. (36°C min / 205°C max.)
Non-operating Temps	-40°F to 158°F (-40°C to +70°C)

HUMIDITY

Operating:	To85% relative humidity (non-condensing)
Non-Operating:	To95% relative humidity (non-condensing)

ALTITUDE

Operating:	to 3,048 Meters
Non-operating:	to 15,240 Meters

INVISACOOK - 4 BURNER UNIT



PRODUCT EMC COMPLIANCE – CLASS B COMPLIANCE

NOTE: The product is required to comply with Class B emission requirements as the end system that it is configured into is intended for a commercial environment and market place. System is to have minimum of 3db margin to Class B Limits.

UL 858 :2014 Ed.16+

EN 55014-1:2017

EN 55014-2:2015+A1:2018

EN 61000-3-2:2019

EN 61000-3-3:2013+A1:2019

CSA C22.2#46:2013 Ed.9

EN 60335-1:2012+A11:2014+A13:2017+A1:2019
+A2:2019

+A14:2019

EN 60335-2-9: 2019

EN 62233:2008

AU/NZ ISO/IEC 17025

G-MARK GLVD0016-0051

TUV (EU) No 66/2014 – 2009/125/EC

WARRANTY

INVISACOOK – 4 Burner Unit – Individual is covered by a two-year consumer warranty that provides product replacement only and a five-year limited warranty.

PRODUCT REGULATORY REQUIREMENTS

Intended Application – This product is intended for indoor or outdoor covered use, not for use in inclement weather.

PRODUCT SAFETY

IEC60950-1 (International)

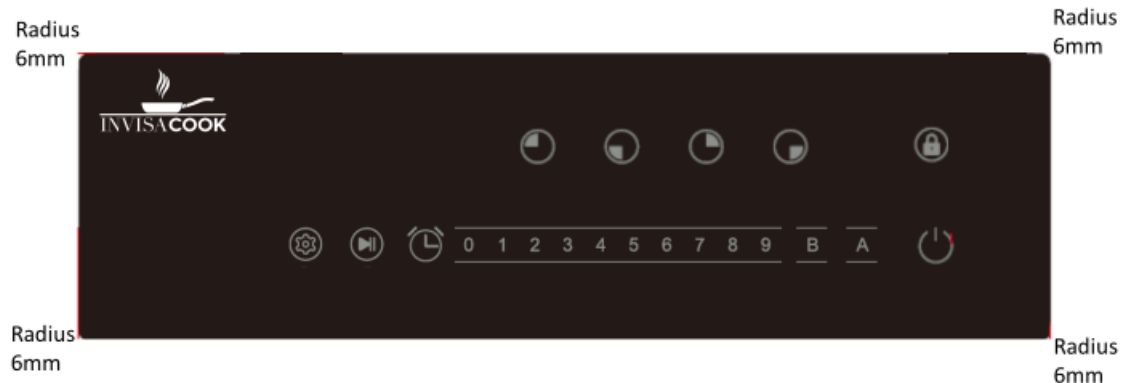

Legal Notices

Information contained in this publication regarding device applications and the like is provided only for your convenience and may be superseded by updates. It is your responsibility to ensure that your application meets with your specifications. "Typical" parameters which may be provided in Energy data sheets and/or specifications can and do vary in different applications and actual performance may vary over time. All operating parameters, including "Typicals" must be validated for your application by your technical experts. INVISACOOK MAKES NO REPRESENTATIONS OR WARRANTIES OF ANY KIND, WHETHER EXPRESS OR IMPLIED, WRITTEN OR ORAL, STATUTORY OR OTHERWISE, RELATED TO THE INFORMATION, INCLUDING BUT NOT LIMITED TO ITS CONDITION, QUALITY, PERFORMANCE, MERCHANTABILITY OR FITNESS FOR PURPOSE. Should the Buyer purchase or use INVISACOOK products for any such unintended or unauthorized application, the Buyer shall indemnify and hold INVISACOOK LLC, and its officers, employees, subsidiaries, affiliates, and distributors harmless against all claims, costs, damages, and expenses, and reasonable attorney fees arising out of, directly or indirectly, any claim of personal injury or death associated with such unintended or unauthorized use, even if such claim alleges that INVISACOOK LLC, et al, was negligent regarding the design or manufacture of the unit in question or claim. No licenses are conveyed, implicitly or otherwise, under any INVISACOOK LLC intellectual property rights.

Copyright © 2018 – INVISACOOK INC

INVISACOOK - 4 BURNER UNIT

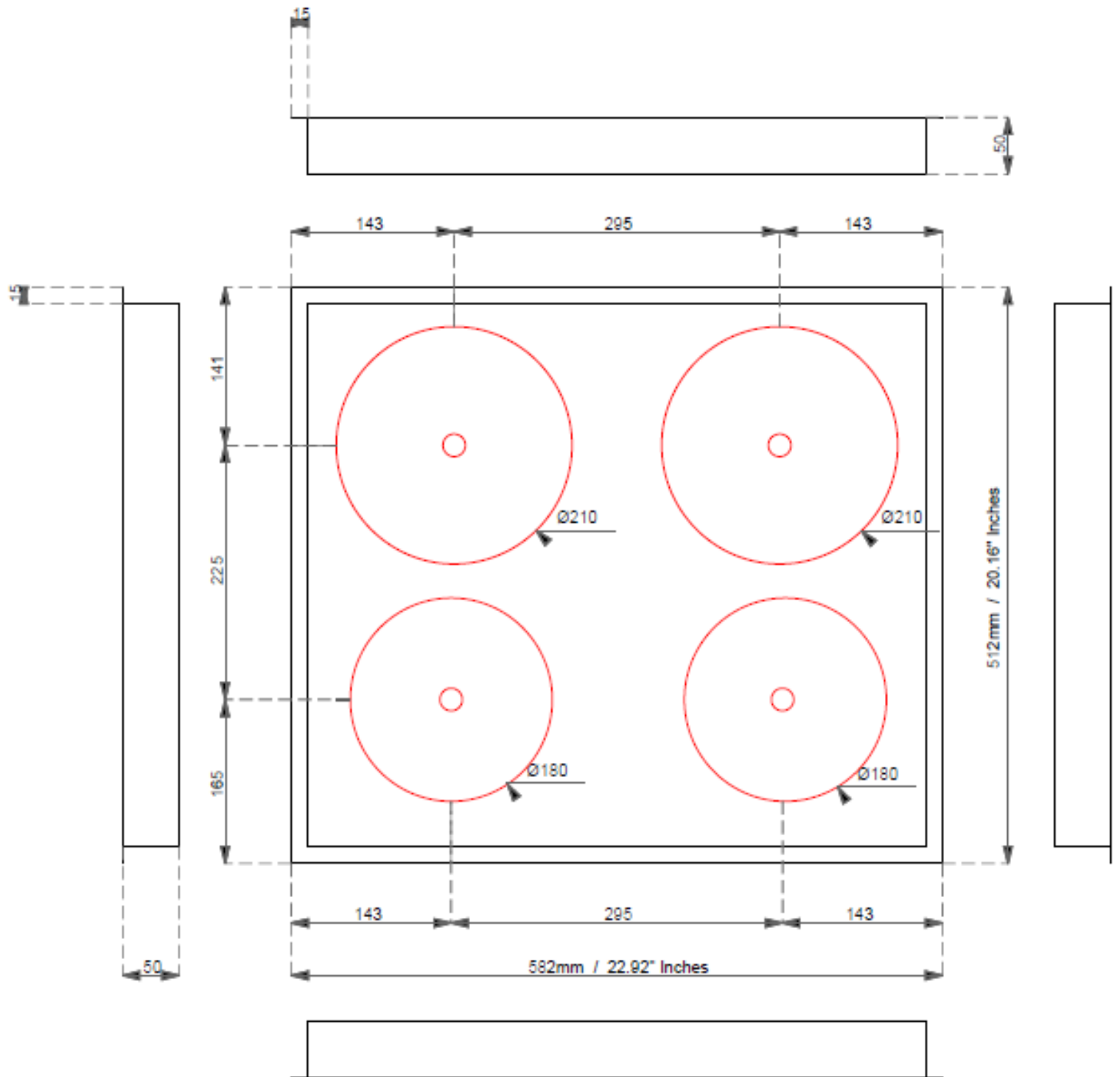



5 Burner 220V Unit

Model Number # 8150-256-001B

DESCRIPTION

INVISACOOK – 5 Burner Unit is a complete, self-contained system. It has 5 induction points to cook thru your Porcelain countertop, evenly and sufficiently. While it has a controller that can be installed anywhere.



FEATURES

- 5 separate burning unit elements
- Power Boost option for faster Water Boiling speed.
- Designed for Undermounting installation for any Porcelain countertop surface in any way possible

DEVICE OPERATION

When a compliant receiver such as an induction quality pan is placed on the induction coil, the unit will automatically adjust the charging power, based on the feedback command from the controller. When searching for connection, LED number will blink red, once pan and unit are connected the LED number will stay illuminated. If the pan moves too far in relation to the induction coil, the LED will blink IC and a Beeping noise will follow, indicating an error in connection. If this (or any other error condition) occurs, try resetting the unit by unplugging it and waiting 10 seconds to reconnect, for an automatic reset.

APPLICATIONS

5 Burner unit can be used in these options and materials:

- Typical House Kitchen
- Multi-Family (Apartments)
- Boats / RVs / Airplanes
- Tiny Houses
- Outdoor Kitchens
- Entertaining Islands or Tables
- Cooking Carts
- **Materials** – Porcelain

Status	Indicator
Off	No power/inactive
Power on	LED lights on Red Dash
Connected	LED Number stays illuminated
Lost of Connection	LED Blinking IC Red
Noise Alert	Beeping Noise of no Connection
Error condition	A Letter Followed by a Number (H-8)

FOREIGN OBJECT DETECTION

INVISACOOK – 5 Burner Unit- Unit contains an algorithm for sensing the presence of foreign objects placed on the unit. When a foreign object is placed on the transmitter coil during operation, the unit will shut down and the LED will flash red showing IC and make a beeping noise.

INVISACOOK - 5 BURNER UNIT



ELECTRICAL AND MECHANICAL SPECIFICATIONS

Dimension	Description
Dimension	905 x 515 x 50mm
Bottom Size	875 x 485 x 49.5mm
Recommended material	Max thickness is 12mm Porcelain

Connection	Description
AC Input	220-240Vac 50/60HZ
Wattage	7,200 W (Total Power Shared) 32.75 AMPs
Max Power Per Burner Platen Burner Size	2000w + 1600w + 2000w + 1600w + 2000w 210mm – 180mm – 210mm – 180mm – 210mm

TEMPERATURE

Operating Cooking Temps	97°F min / 400 °F max. (36°C min / 205°C max.)
Non-operating Temps	-40°F to 158°F (-40°C to +70°C)

HUMIDITY

Operating:	To 85% relative humidity (non-condensing)
Non-Operating:	To 95% relative humidity (non-condensing)

ALTITUDE

Operating:	to 3,048 Meters
Non-operating:	to 15,240 Meters

INVISACOOK - 5 BURNER UNIT



WARRANTY

INVISACOOK – 5 Burner Unit – Individual is covered by a two-year consumer warranty that provides product replacement only and a five-year limited warranty.

PRODUCT REGULATORY REQUIREMENTS

Intended Application – This product is intended for indoor or outdoor covered use, not for use in inclement weather.

PRODUCT SAFETY

IEC60950-1 (International)

PRODUCT EMC COMPLIANCE – CLASS B COMPLIANCE

NOTE: The product is required to comply with Class B emission requirements as the end system that it is configured into is intended for a commercial environment and market place. System is to have minimum of 3db margin to Class B Limits.

UL 858 :2014 Ed.16+

EN 55014-1:2017

EN 55014-2:2015+A1:2018

EN 61000-3-2:2019

EN 61000-3-3:2013+A1:2019

CSA C22.2#46:2013 Ed.9

EN 60335-1:2012+A11:2014+A13:2017+A1:2019

+A2:2019+A14:2019

EN 60335-2-9:2019

EN 62233:2008

AU/NZ ISO/IEC 17025

G-MARK GLVD0016-0051

TUV (EU) No 66/2014 – 2009/125/EC

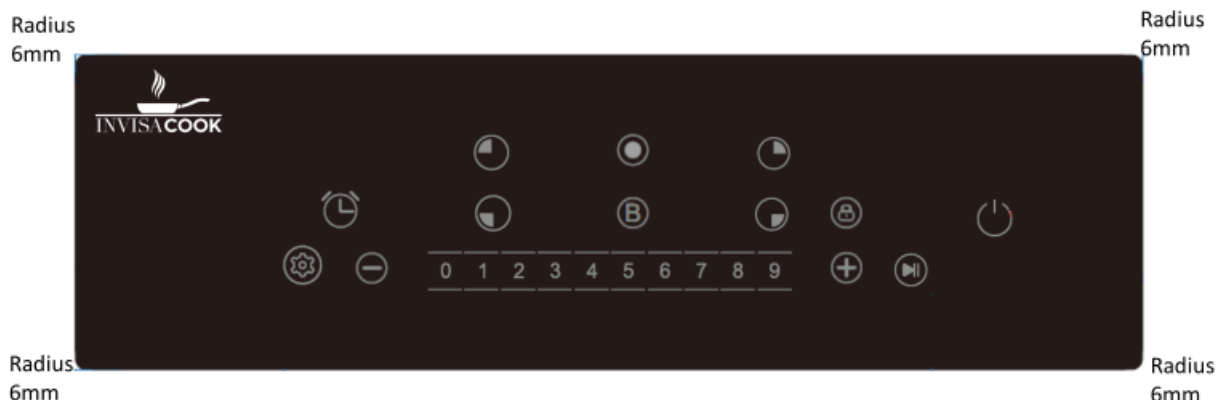

Legal Notices

Information contained in this publication regarding device applications and the like is provided only for your convenience and may be superseded by updates. It is your responsibility to ensure that your application meets with your specifications. "Typical" parameters which may be provided in Energy data sheets and/or specifications can and do vary in different applications and actual performance may vary over time. All operating parameters, including "Typicals" must be validated for your application by your technical experts. INVISACOOK MAKES NO REPRESENTATION OR WARRANTIES OF ANY KIND, WHETHER EXPRESS OR IMPLIED, WRITTEN OR ORAL, STATUTORY OR OTHERWISE, RELATED TO THE INFORMATION, INCLUDING BUT NOT LIMITED TO ITS CONDITION, QUALITY, PERFORMANCE, MERCHANTABILITY OR FITNESS FOR PURPOSE. Should the Buyer purchase or use INVISACOOK products for any such unintended or unauthorized application, the Buyer shall indemnify and hold INVISACOOK LLC, and its officers, employees, subsidiaries, affiliates, and distributors harmless against all claims, costs, damages, and expenses, and reasonable attorney fees arising out of, directly or indirectly, any claim of personal injury or death associated with such unintended or unauthorized use, even if such claim alleges that INVISACOOK INC et al, was negligent regarding the design or manufacture of the unit in question or claim. No licenses are conveyed, implicitly or otherwise, under any INVISACOOK INC intellectual property rights.

Copyright © 2018 – INVISACOOK INC



INVCH

Long Distance Wireless Charger

7.5W/5W/10W

Invisible Wireless Charger



Key Features:

- Compatible with Qi-BPP 5W, iPhone 7.5W and Samsung 10W
- Support all Qi standard mobile phones
- Used for 15~50mm charging distance through non-metallic solid material between mobile phone and the charger available
- Easy installation
- Resonator pad increases the efficiency and speed of charging
- Over-current/Over-temperature/Over-voltage
- Can meet the FCC, CE and UKCA requires
- Can meet the UL and RoHS requires

INVCH is a simple yet sophisticated wireless charger that enables devices to charge by simply placing them on a work surface. Perfect for the home or the office, INVCH compact design subtly attaches to the bottom of a desk or tabletop to keep mobile devices powered throughout the day.

No touchpoints—simply place your mobile device on the table to charge. Wirelessly charge up to 10W of Qi-compatible devices.

Can penetrate all kinds of desktop except metal, the distance up to 50mm

Specification	
Power Input Interface	DC Jack $\phi 3.5 * \phi 1.35$
Input Power	DC: 24V 1A
Charging Power	5W、7.5W、10W (max.)
Support Protocol	Compatible with Qi-BPP, iPhone Fast Charge, Samsung Fast Charge
Standby Power	<0.2W
Charging Distance	15~50mm
Horizontal Freedom	+/- 20 mm
Typical Efficiency	84% @ 30mm (iPhone X); 72% @ 30mm (iPhone 12pro)
Operating Frequency	125~145KHz
Coil Type	Litz wire wound with ferrite
Operating Environment	0 C ~ 40 C (32 F ~ 104 F)
	15 ~ 85% RH (Non-dewling)
Storage Environment	-20 C ~ 70 C (-4 F ~ 158 F)
	5 ~ 95% RH (Non-dewling)

Mechanical Specification:

Outline Dimension 119 mm (l) x 119 mm (w) x 15.5 mm(h)

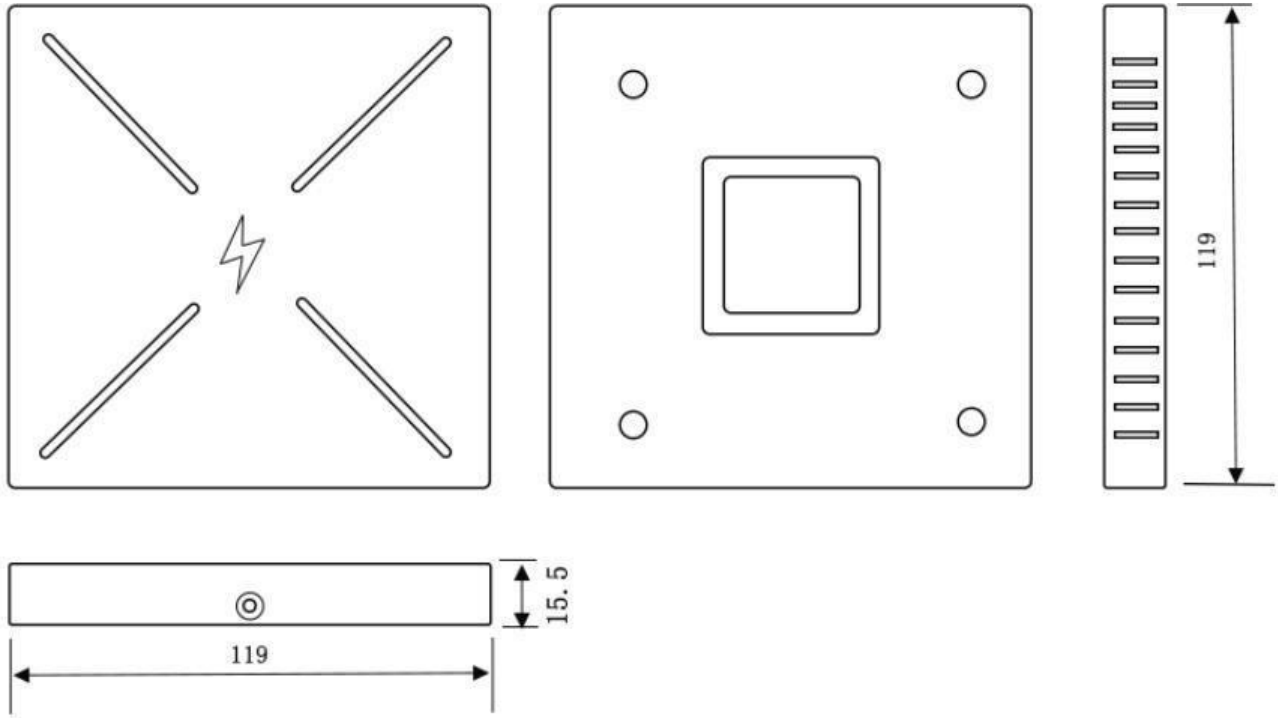

Resonator Pad Size OD 101 mm, 1 mm max. thickness (Can be Customized)



Unit: mm

ROBERT E. HENRY

TILE COMPANY

EST. 1933



INVISACOOK

The Original



Parts and Pieces that come with the Rail Installation Pack



8 Pieces of 16mm Button Head Socket Cap Screws, Stainless Steel 18-8 (304), Black Finish, for Aluminum Profile of L-Bracket to T-Bar



8 Pieces of T Sliding Nuts Hammer Nut Block Square Nuts M5 T Nuts for Aluminum Profiles of L-Bracket to T-Bar



8 Pieces of Wood Screws 3/4 Inch, Premium Flat Head Phillips Black Wood Screws, Self Tapping Electrophoresis Used in Indoor Furniture, Woodworking (#8 x 3/4") For screwing the L-Bracket into cabinet wall.

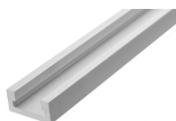

2 Pieces of 22" Miter T Track



4 Pieces of 11" T-Bar with Designated holes for L-Bracket assembly



4 x Corner Bracket 78x78mm for Aluminum Extrusion Profile, 4 Hole Inside Strong Support Corner Brackets



Included Parts and Pieces:

2 x 22" (560mm) Anti-Vibration Strips

2 x Miter T-Track, T-Bar and Corner Bracket Assembly

8 x 3/4" (20mm) Wood Screws

IMPORTANT NOTES FOR PROPER INSTALLATION BY GUIDANCE OF PORCELAIN MANUFACTURES

- Burners are to be a **minimum of 25cm or 9.75" Inches** away from any open ends or Edges of the Countertop Material. This means that from the outside Edge of the Unit (Back part of the Lip) should be a Minimum of 9cm or 3.5" Inches away from any countertop Edge.

****See diagram below****

- All corners are to be round edges as instructed by the Materials Specification for the Porcelain fabricated slabs.

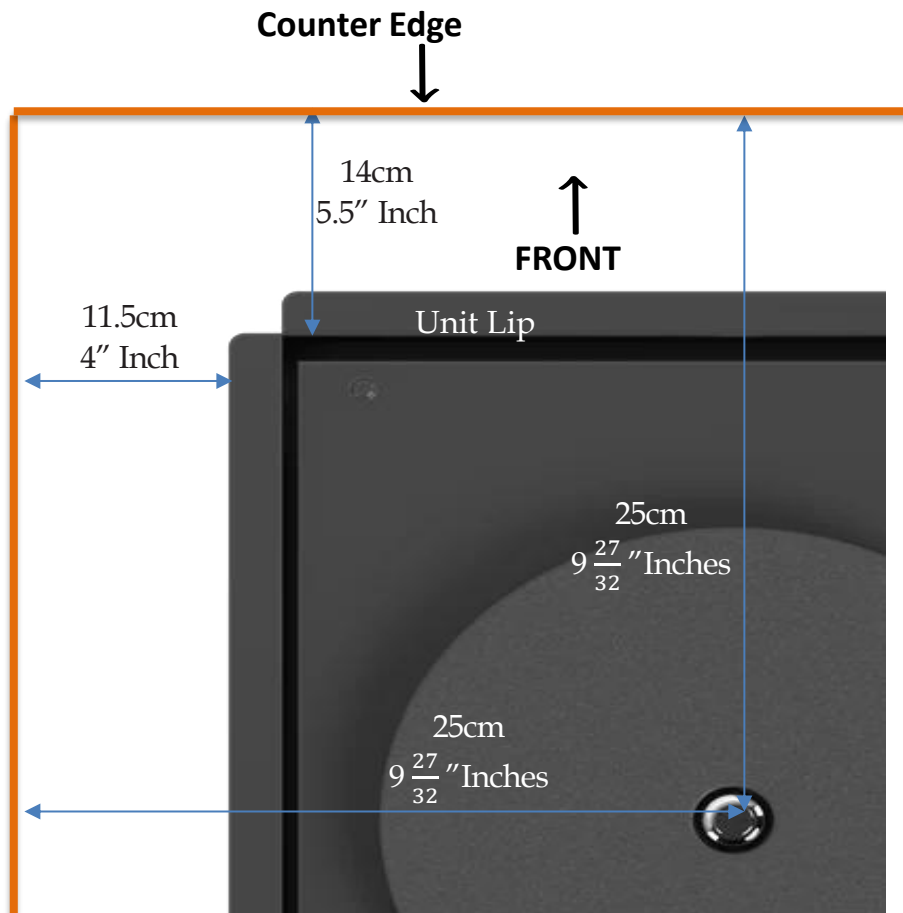

Minimum Dimensions to Counter Edge

Measurements to front of unit, for Back and Sides, make sure to see next pages, with countertop depth and width minimum requirements.

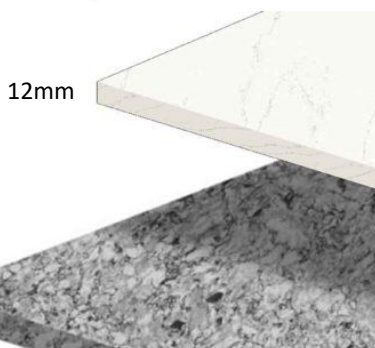

Invisacook can only be used with a minimum countertop ickness of 12mm (1/2") and Max thickness of 20mm (2cm) (3/4") Countertops from tested and approved brands



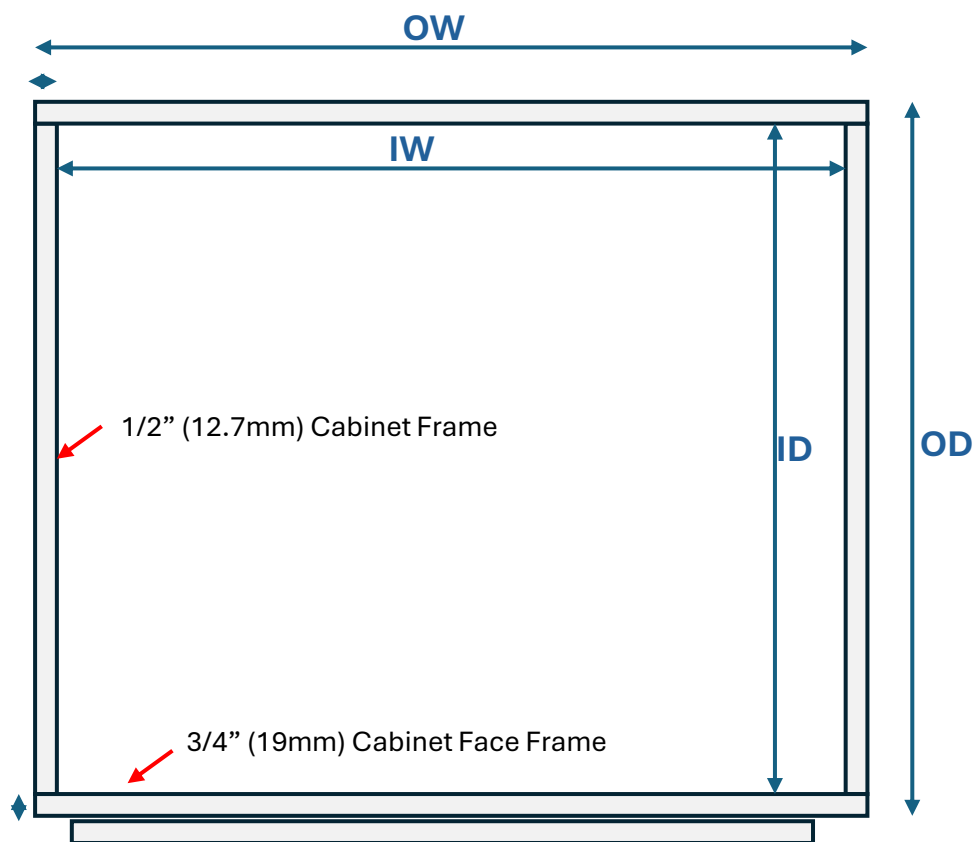

Standard North American Cabinet

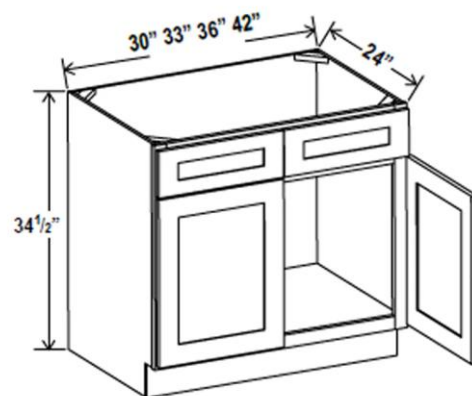

OW = Outside Width
 IW = Inside Width
 OD = Outside Depth
 ID = Inside Depth

Can be adjusted to fit within a Width Cabinet of 24", 28", 30", 34", 36", 38", 40", & 42" cabinet base.

5 Burner in a 38", 40" or 42" Cabinet bases

4 Burner in Row in a 38", 40", & 42" Cabinet bases

4 Burner in a 24", 28", 30", 34", 36", 38", 40", & 42" Cabinet Bases

3 Burner in a 32", 34", 36", 38", 40", & 42" Cabinet Bases

2 Burner in a 24", 28", 30" & 34" cabinet base

For Cabinets of 20", 18", 16" & 14", which only applies for the 1 and 2 Burner units, these braces will be installed Vertically in any of these 24" deep cabinet bases

2 Burner in a 20", 18", 16" & 14" Cabinet Base

1 Burner in a 20", 18", 16" & 14" Cabinet Bases



5 Burner 220V

8150-256-001B



5 Burner Framed in Installation of Rail for Island Use Only

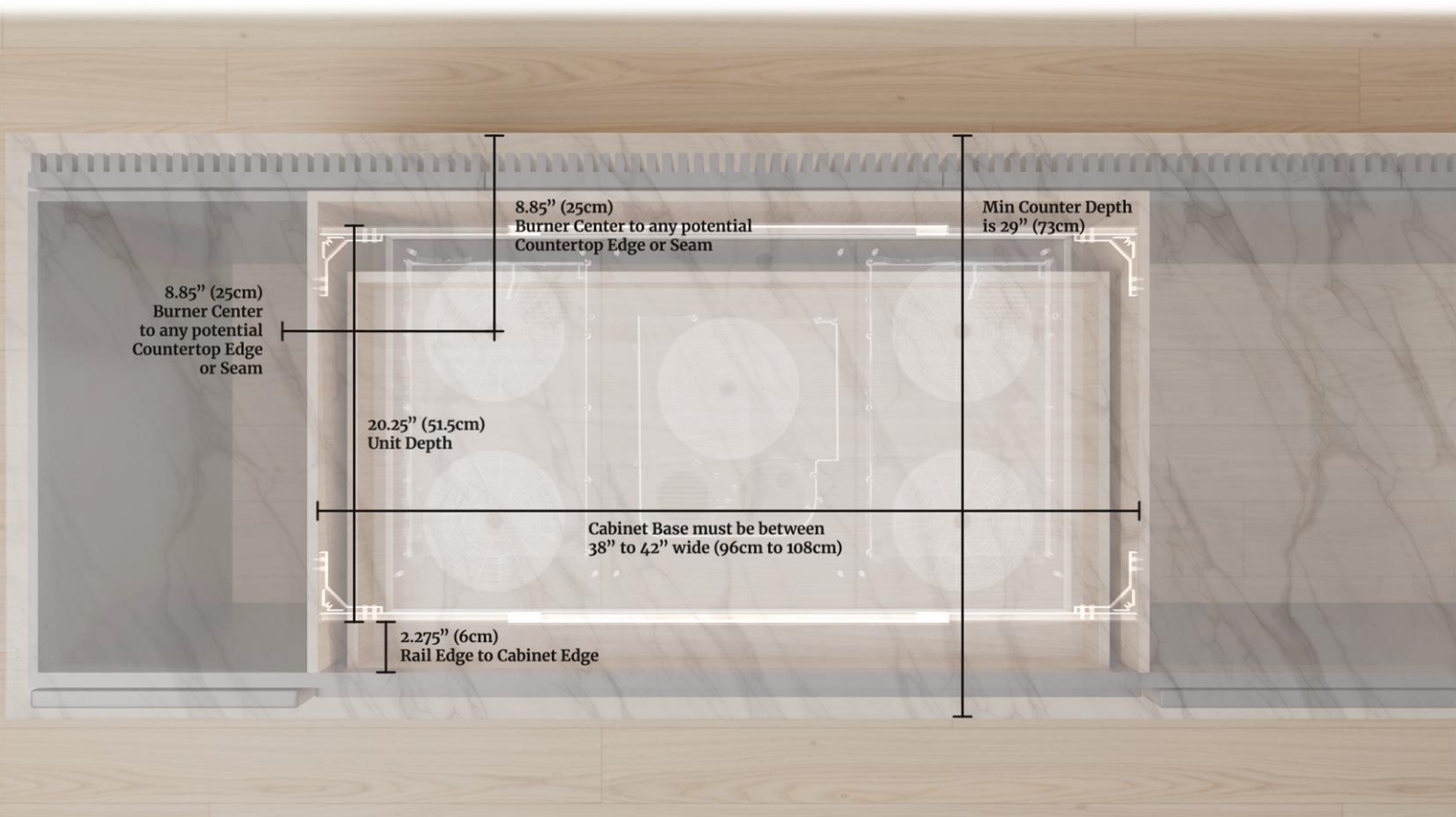
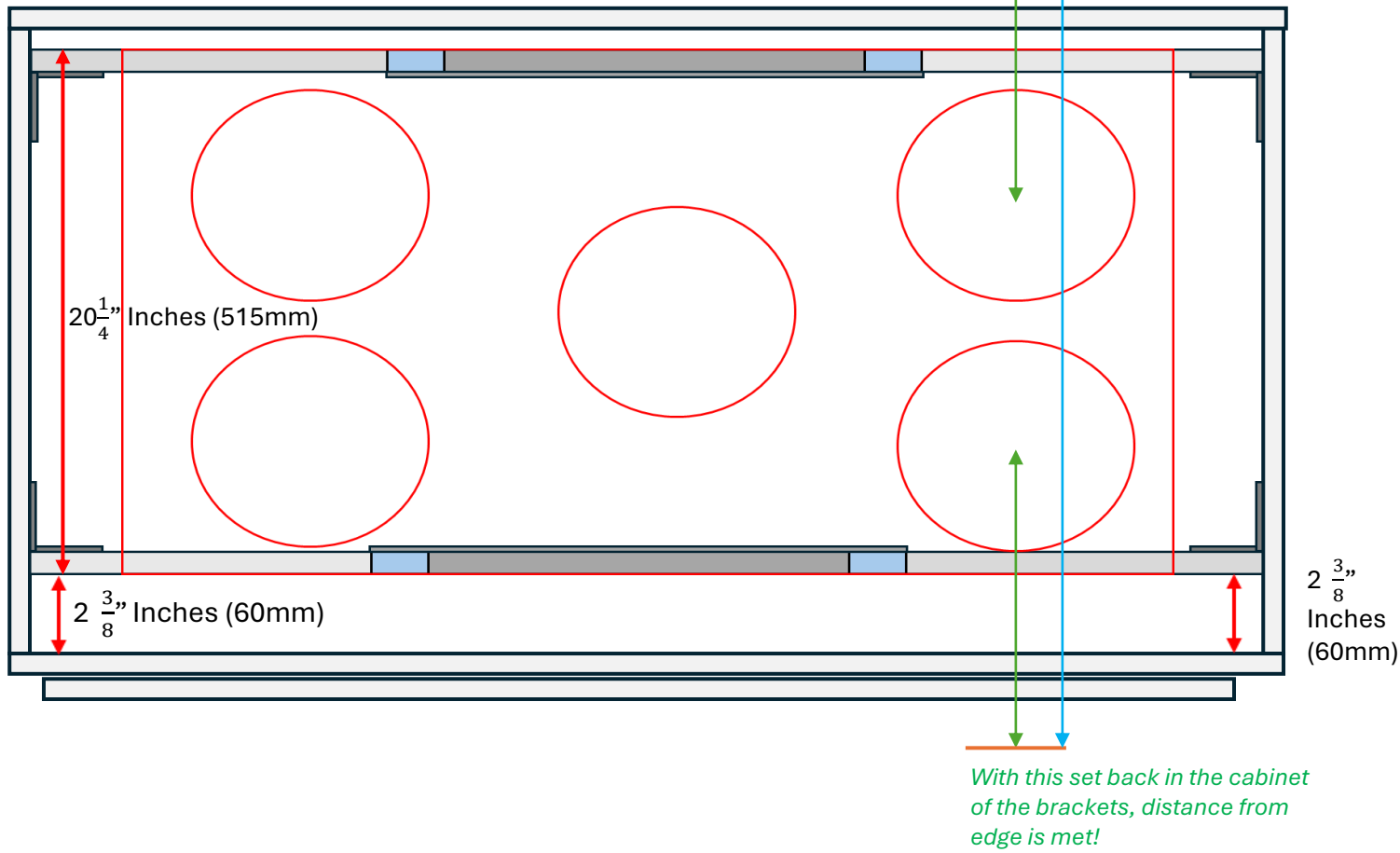



4 Burner Squared 220V

8140-257-001B



**4 Burner Framed in
Installation of Rail for
Island Installation Only**

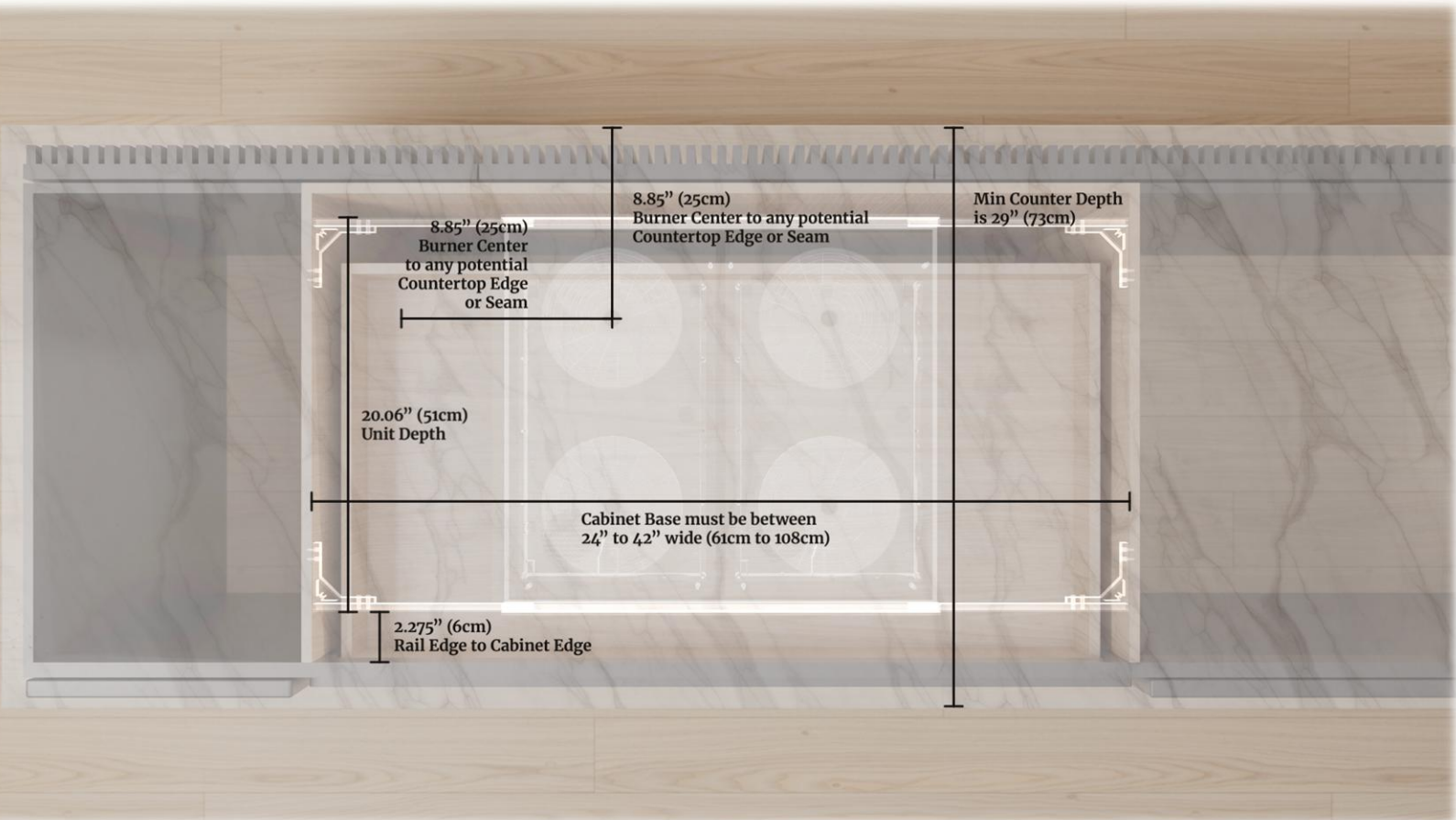
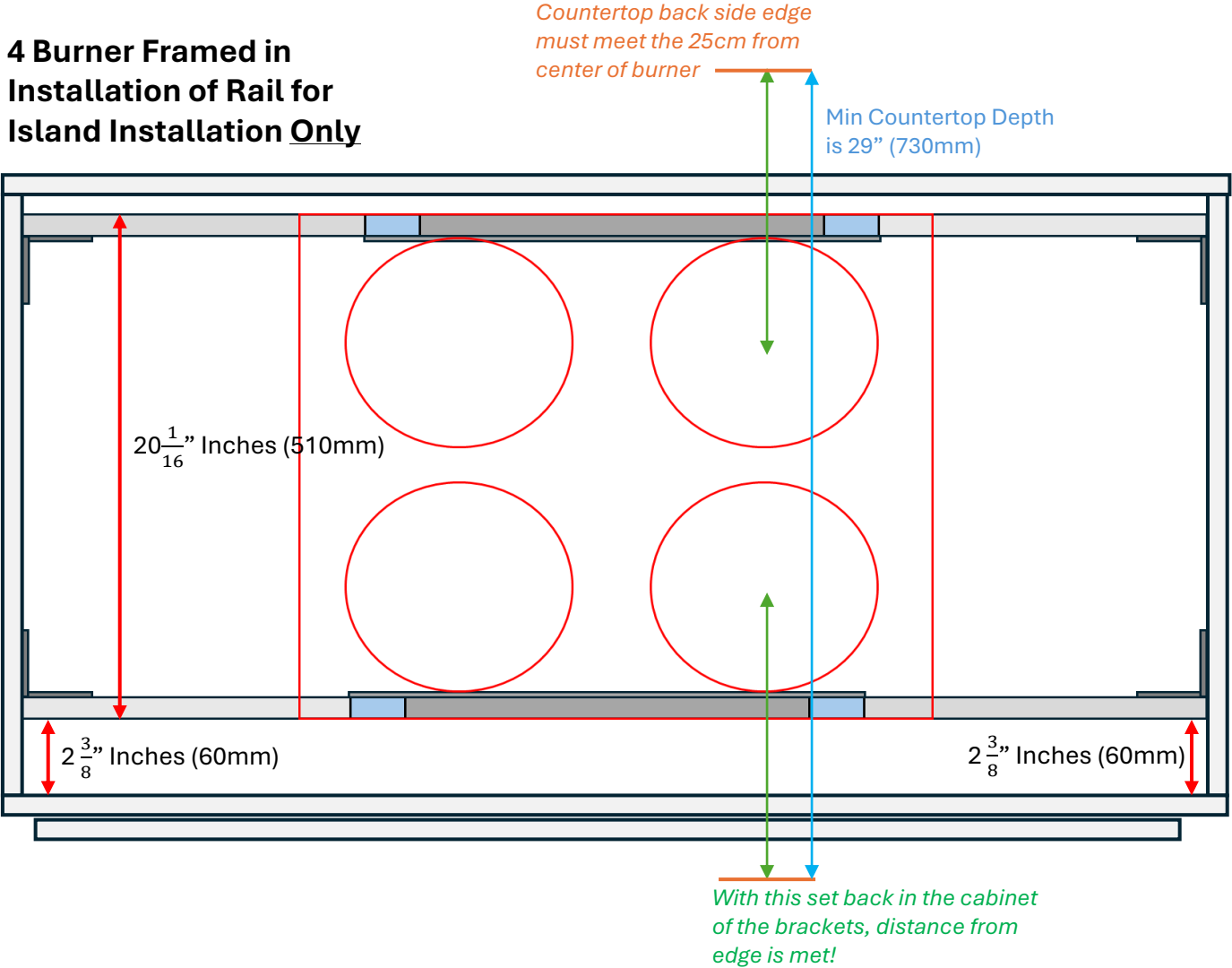



4 Burner Galley 220V

8145-257-001B



4 Burner Straight Row, Framed in Installation of Rail in Galley Kitchen Use or Island

Countertop back side edge
must meet the 25cm from
center of burner

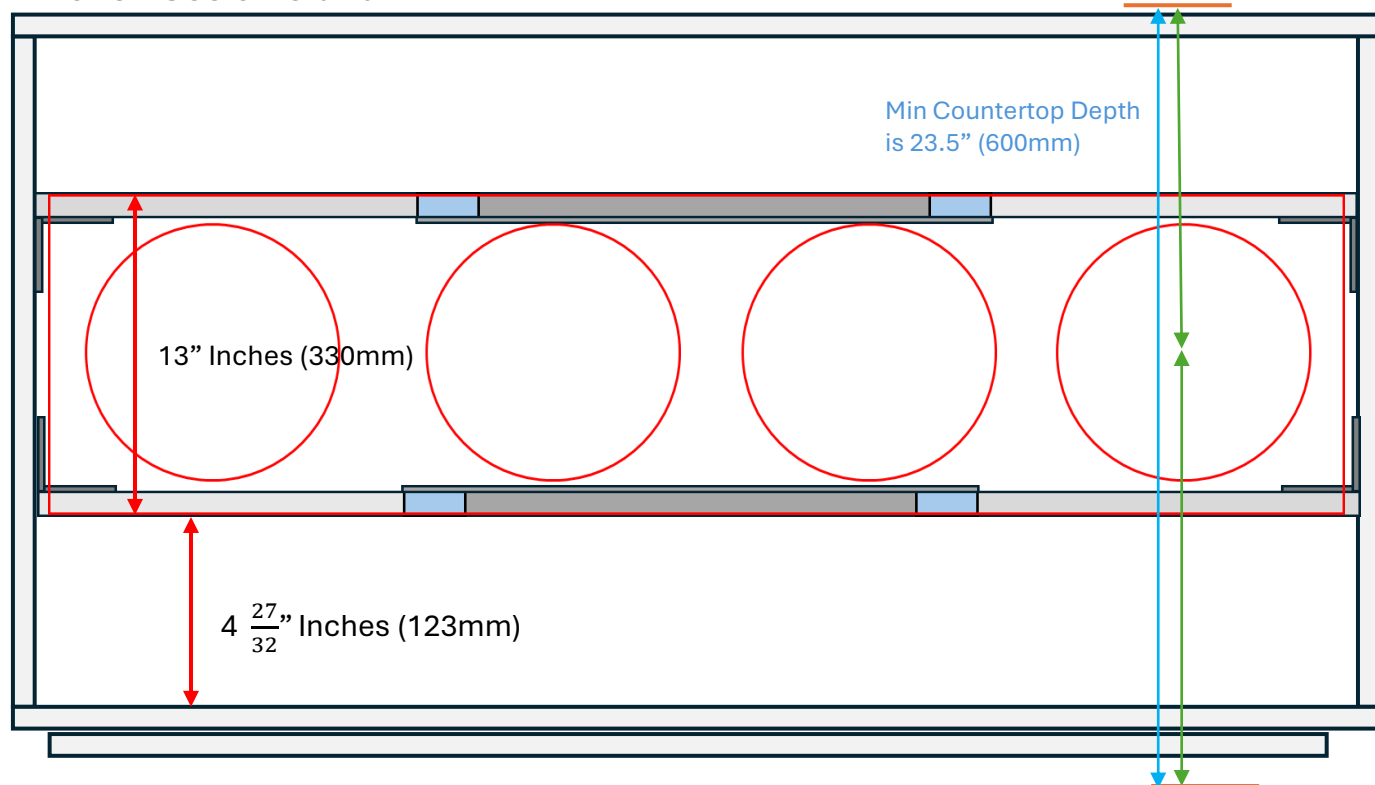

With this set back in the cabinet
of the brackets, distance from
edge is met!

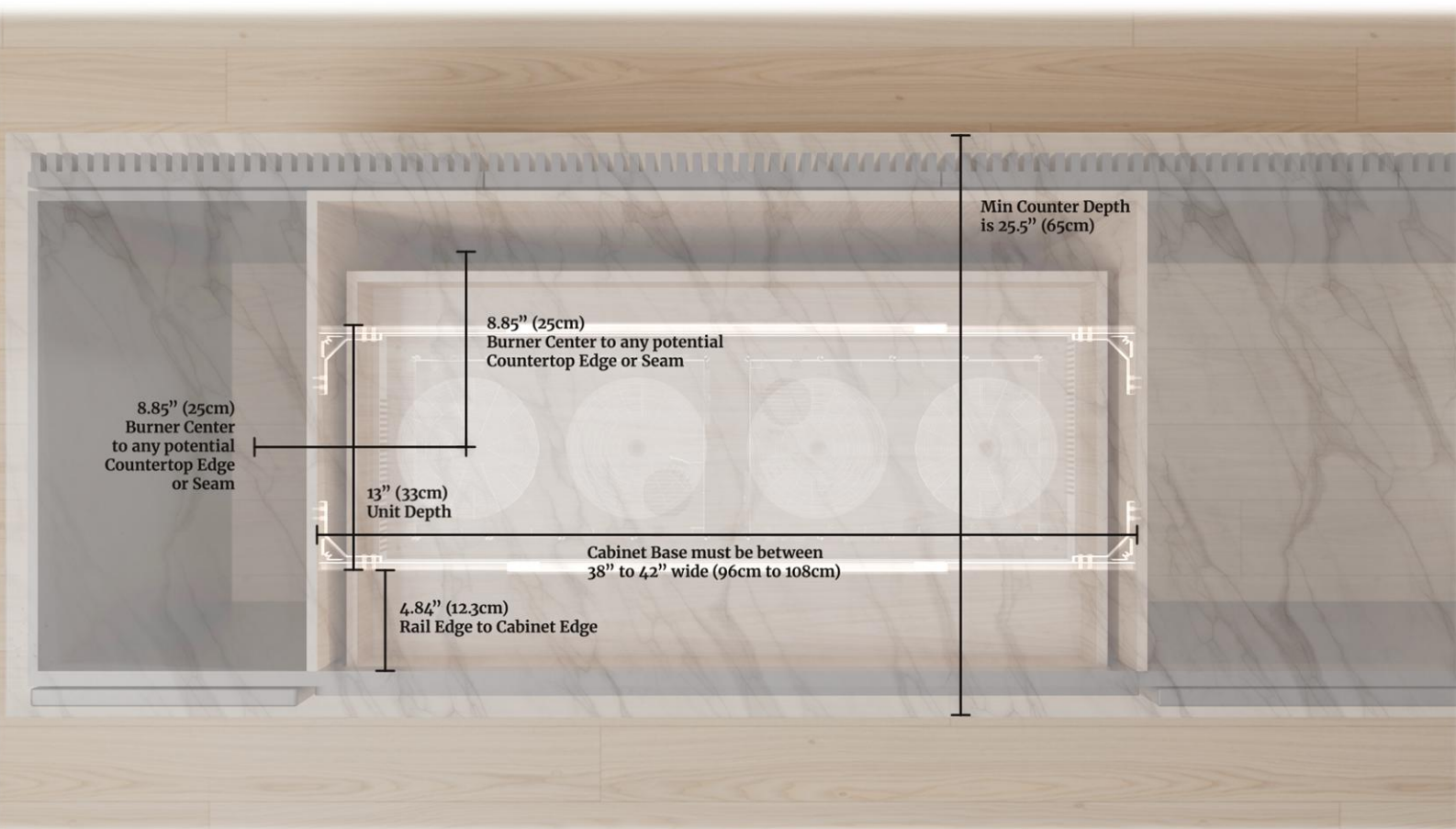



3 Burner 220V

8134-256-001B



3 Burner Framed in
Installation of Rail
in a Galley Kitchen

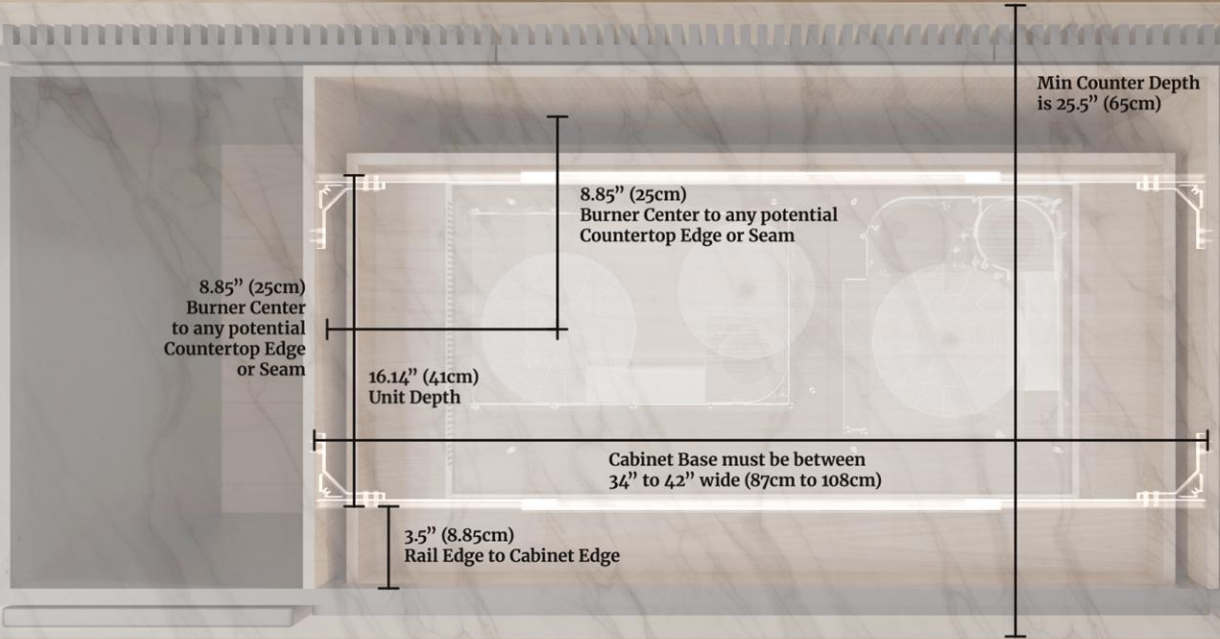
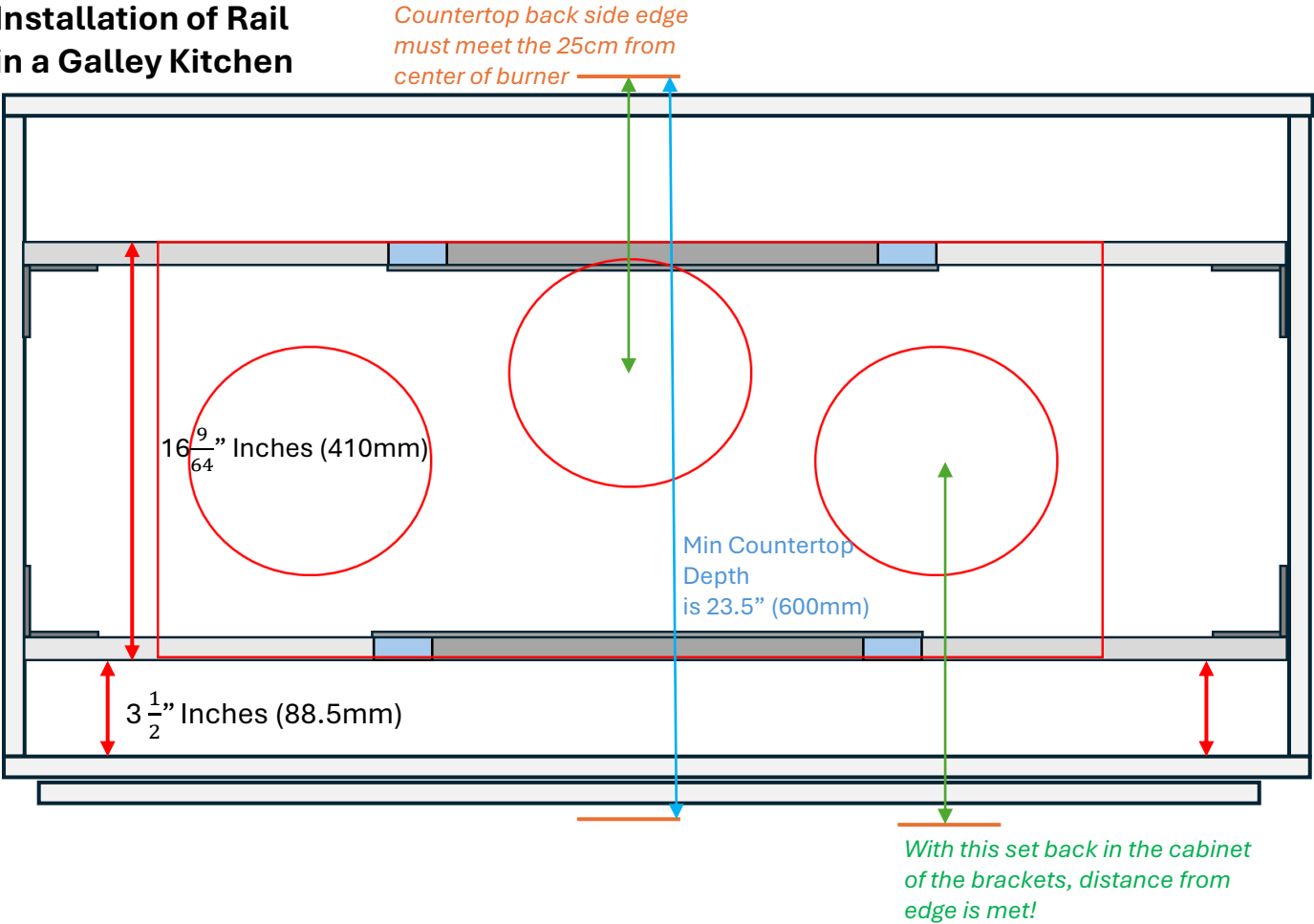



2 Burner 110V or 220V

8121-257-001B



2 Burner Framed in
Installation for Rail in
Island Use Only

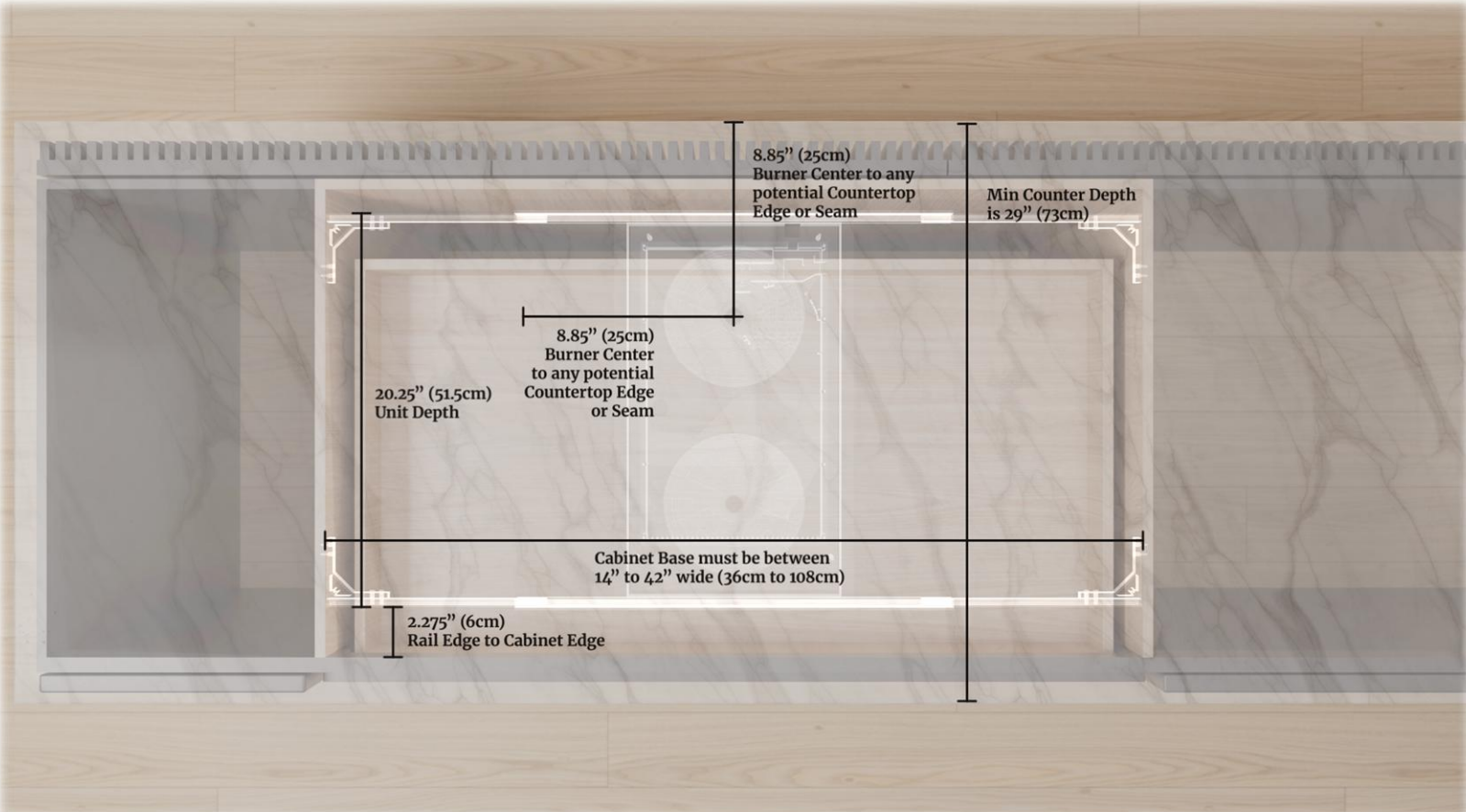
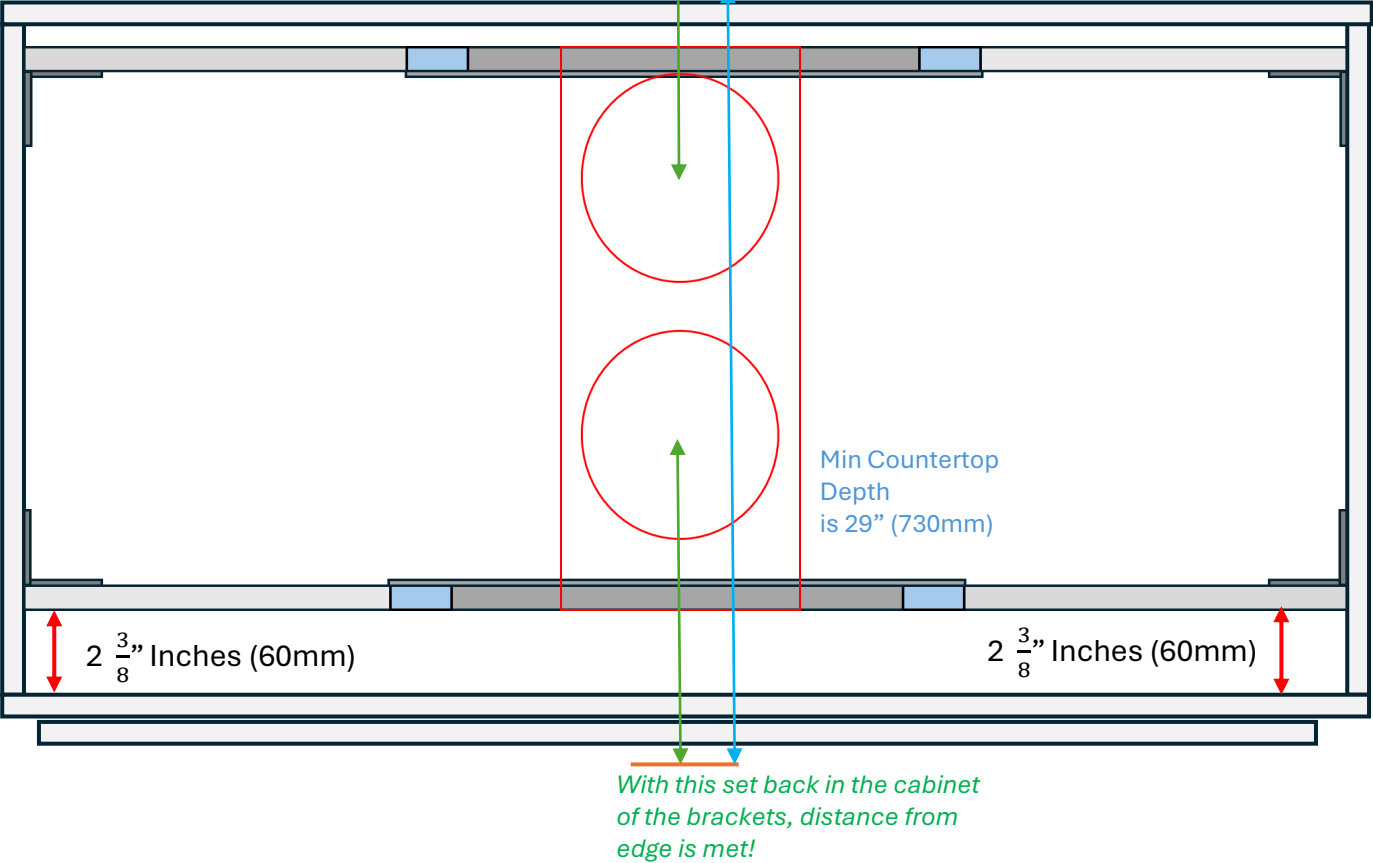

2 Burner Framed in
Installation of Rail System
for Galley Kitchen Use

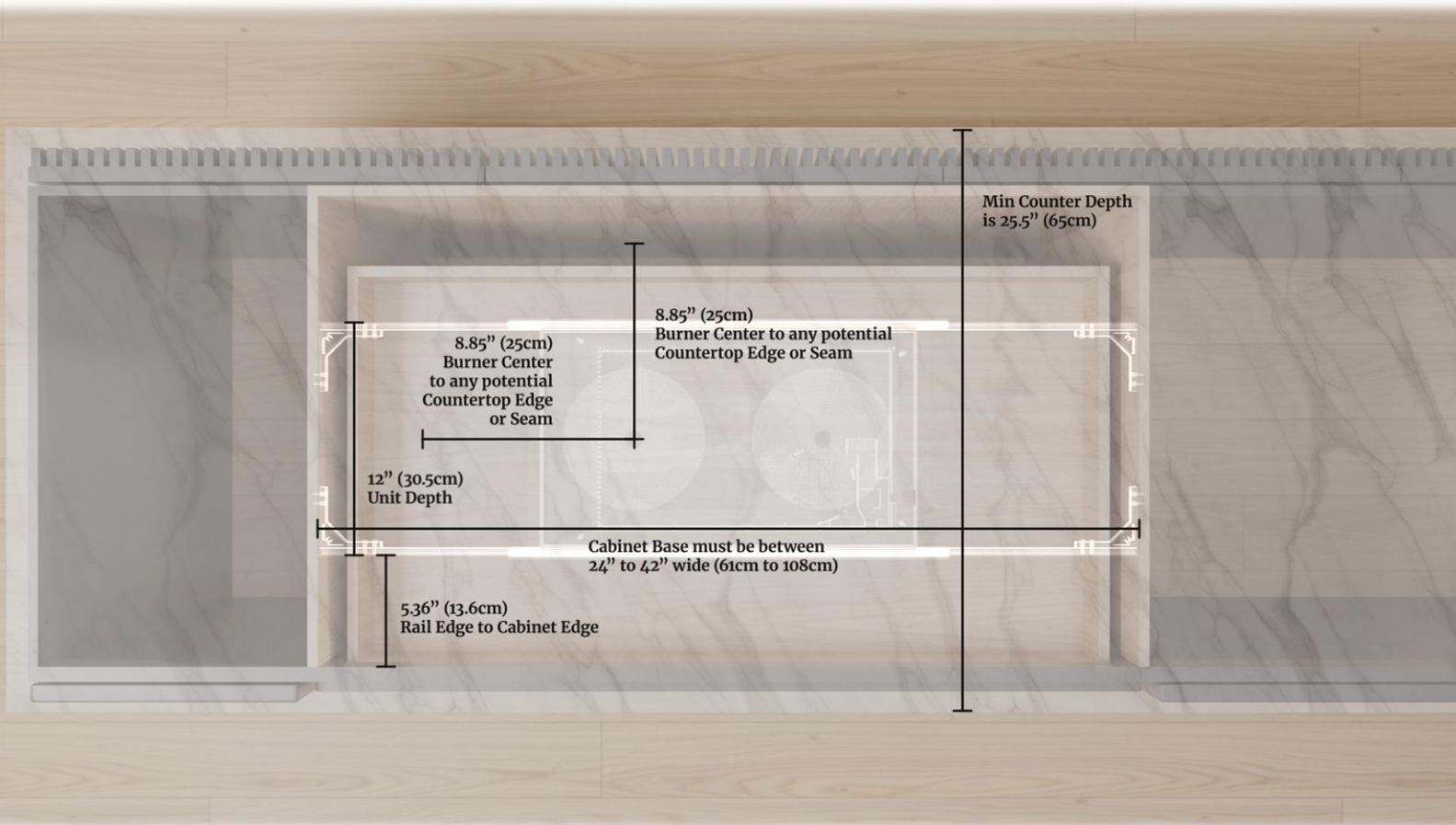
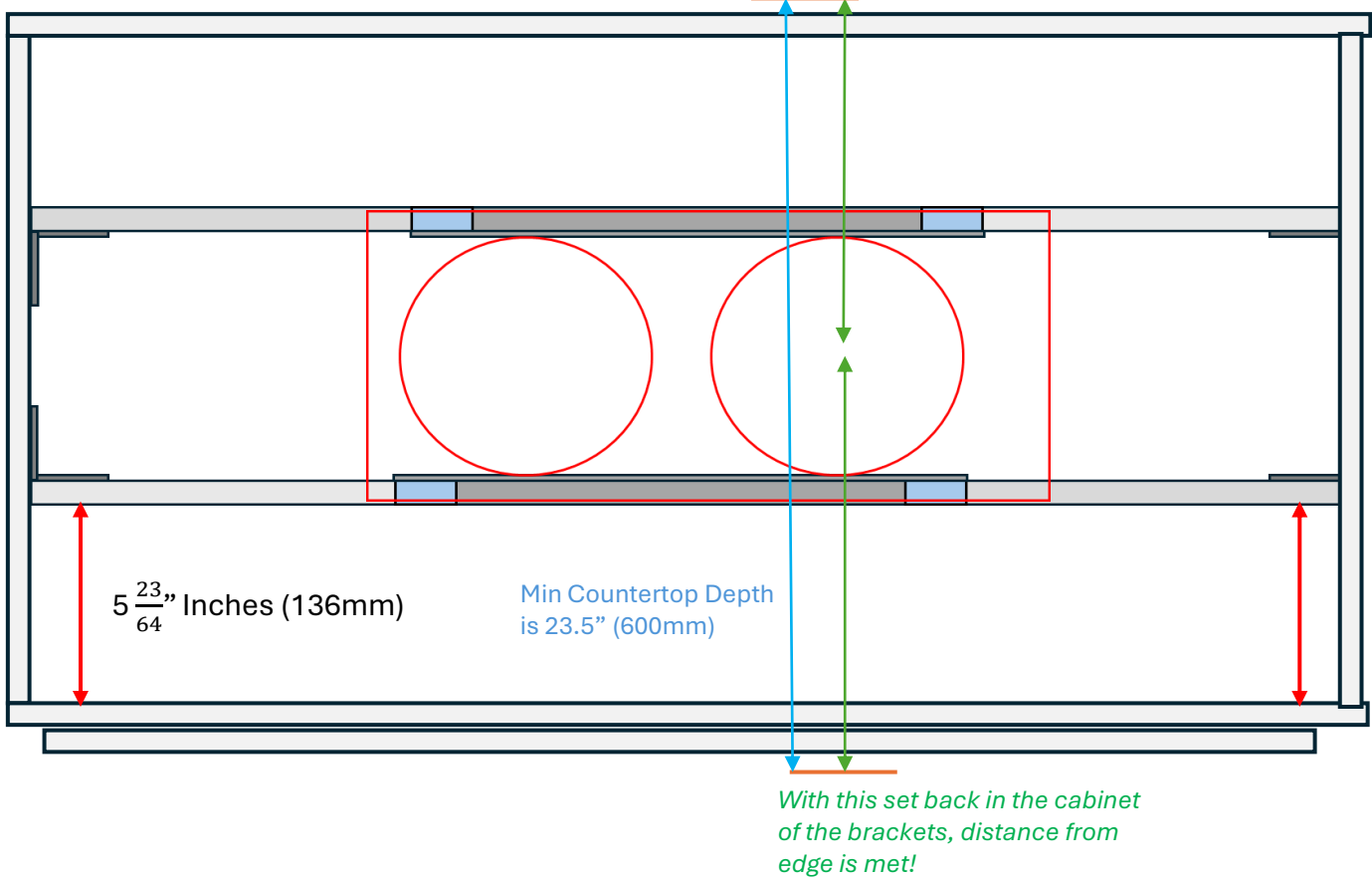



1 Burner 110V or 220V
8113-256-001B



**1 Burner Framed in Installation
of Rail System for Galley Kitchen**

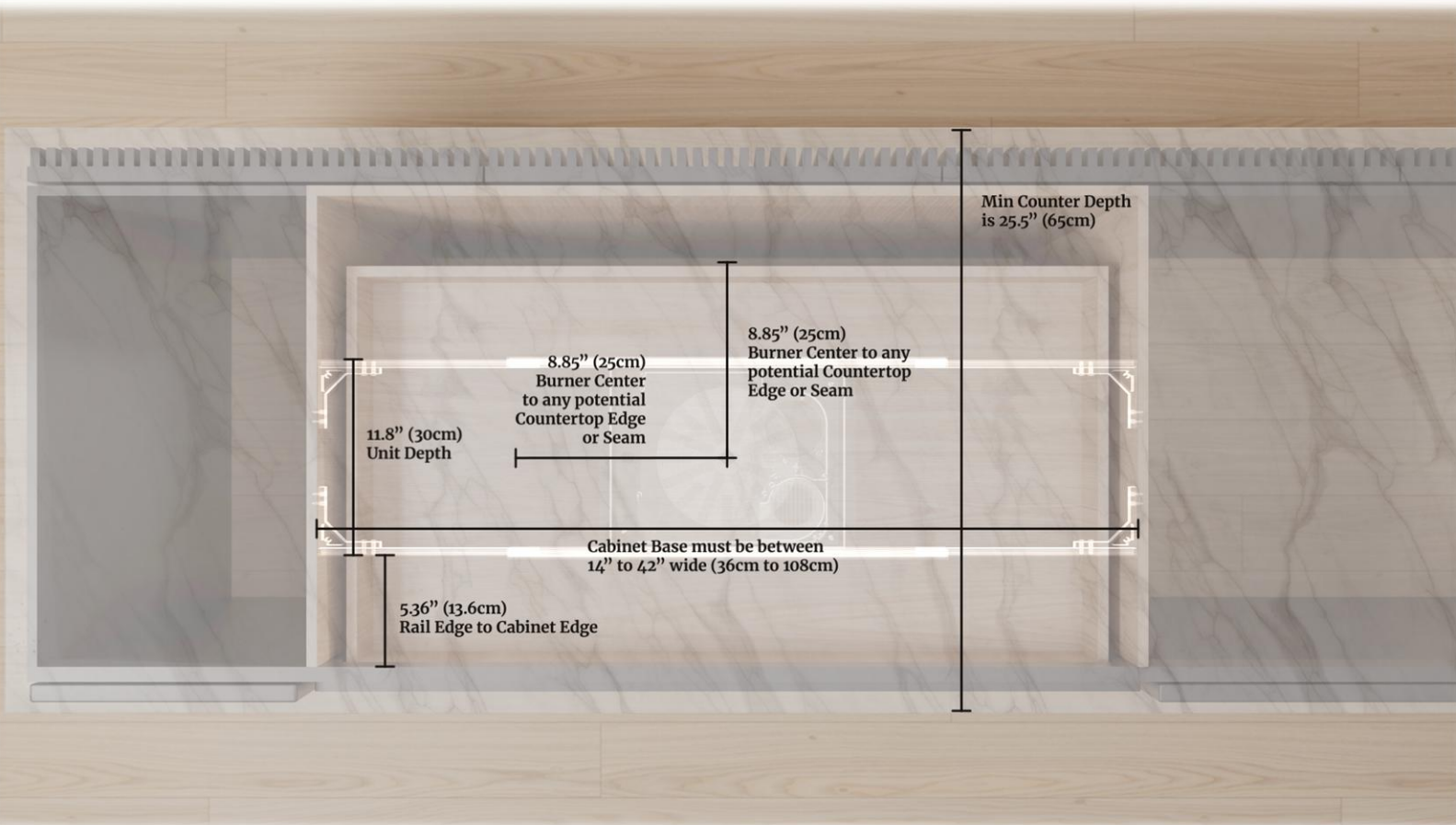
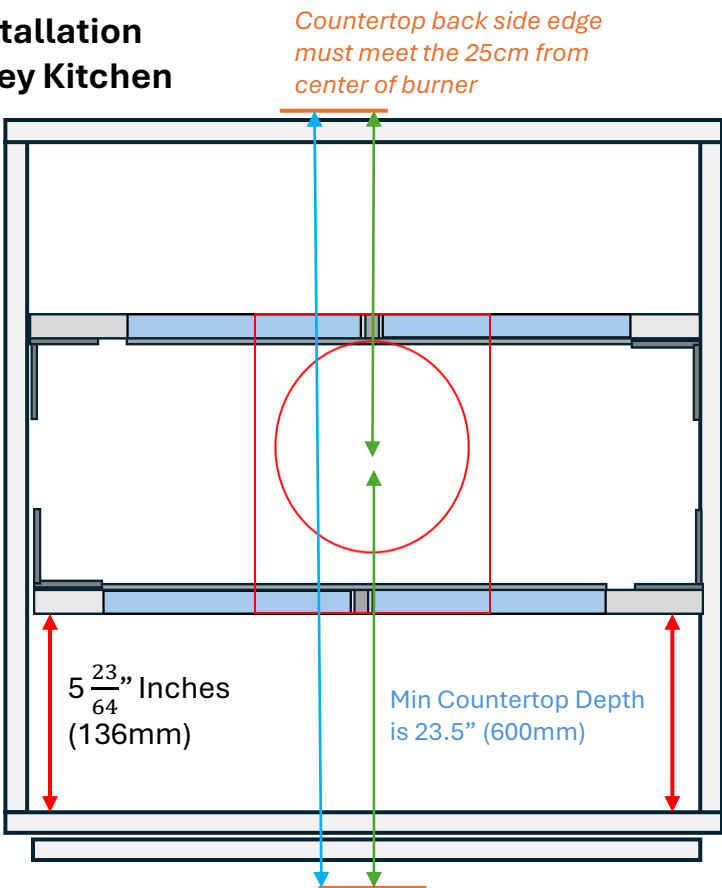

1 & 2 Burner Framed in Installation for Rail in Cabinets smaller

then 22" must be installed Vertical

Countertop back side edge
must meet the 25cm from
center of burner

Countertop back side edge
must meet the 25cm from
center of burner

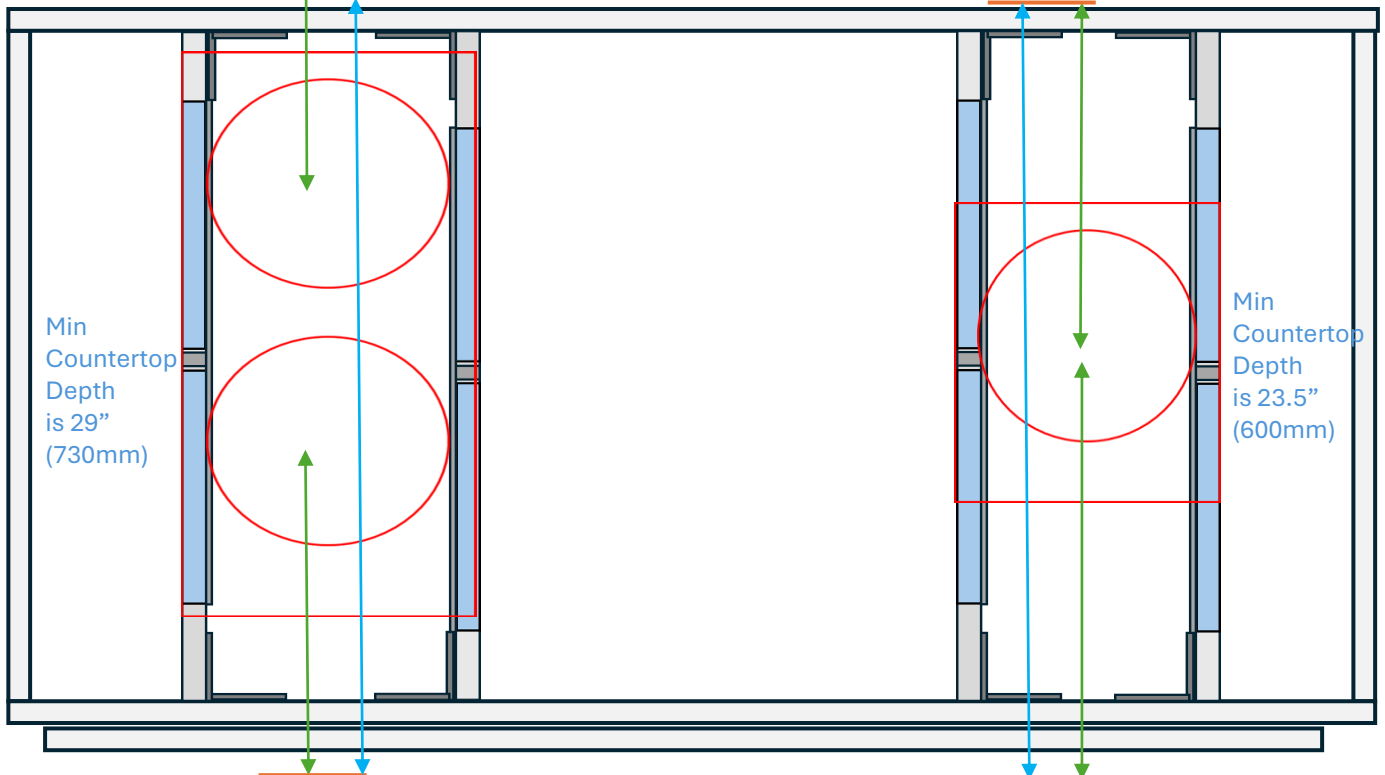

With this set back in the cabinet
of the brackets, distance from
edge is met!

With this set back in the cabinet
of the brackets, distance from
edge is met!



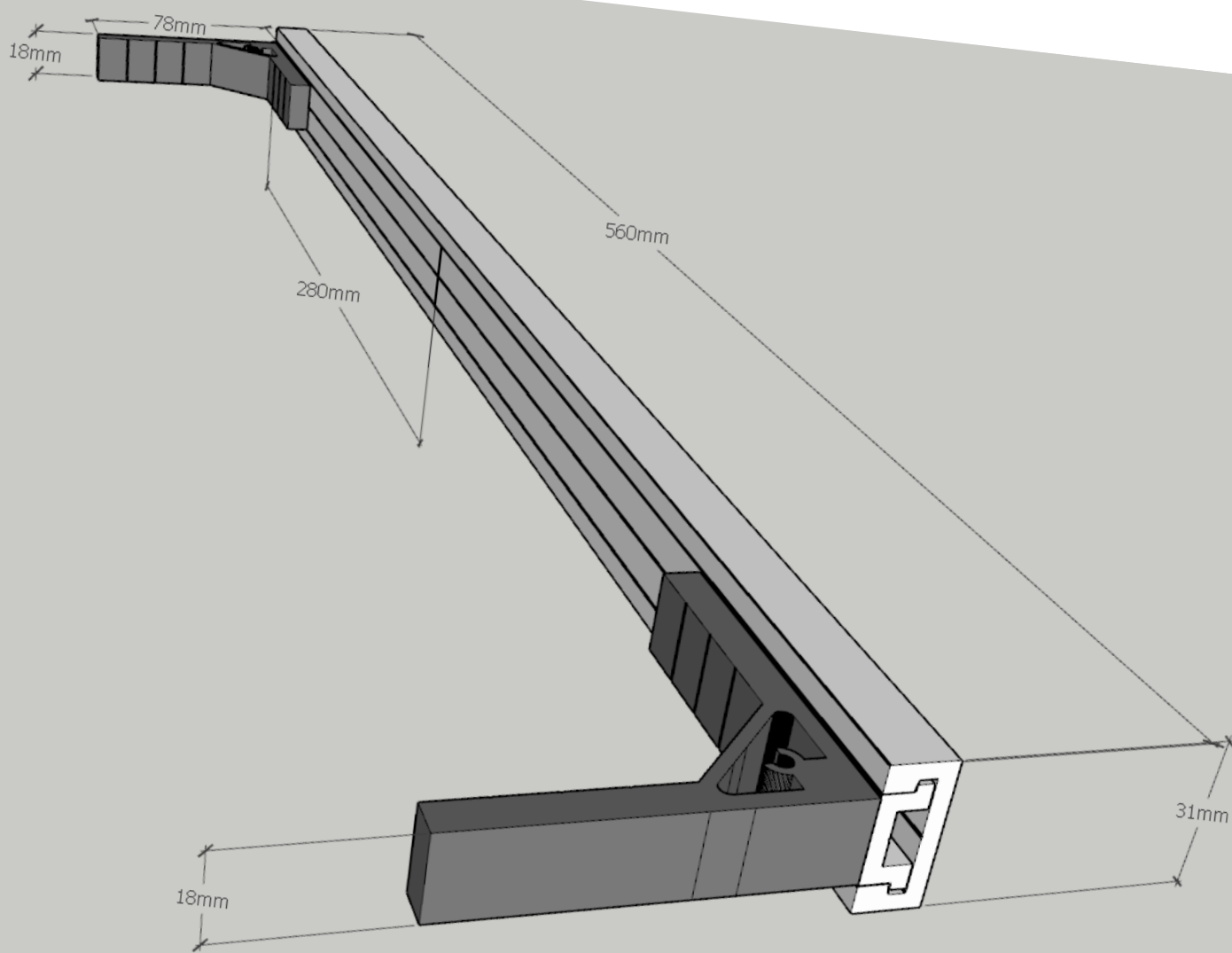

┐ .25 in (6 mm) from top of cabinet frame

Step 3
Screw in corner brackets
to cabinet frame.

INVISACOOK® COOKTOP LIMITED WARRANTY

ATTACH YOUR RECEIPT HERE. PROOF OF PURCHASE IS REQUIRED TO OBTAIN WARRANTY SERVICE.

Please have the following information available when you call the Customer Service Center:

- Name, address and telephone number
- Model number and serial number
- A clear, detailed description of the problem
- Proof of purchase including dealer or retailer name and address

IF YOU NEED SERVICE:

1. Before contacting us to arrange service, please determine whether your product requires repair. Some questions can be addressed without service. Please take a few minutes to review the User Manual for possible user error tips, resources, or visit <http://www.invisacook.com/>.
2. All warranty service is provided exclusively by our authorized Invisacook Service Providers. In the U.S. and Canada, direct all requests for warranty service to:

Invisacook Customer Service

In the U.S.A., call 1-386-263-8578. On WhatsApp, call 1-386-240-2448

If outside the 50 United States or Canada, contact your authorized Invisacook dealer to determine whether another warranty applies.



THREE YEAR LIMITED WARRANTY

WHAT IS COVERED

FIRST THREE YEAR LIMITED WARRANTY (PARTS AND LABOR)

For three years from the date of purchase, when this major appliance is installed, operated and maintained according to instructions attached to or furnished with the product, Invisacook brand of Invisacook Corporation (hereafter "Invisacook") will pay for factory specified replacement parts and repair labor to correct defects in materials or workmanship that existed when this major appliance was purchased or, at its sole discretion replace the product. In the event of product replacement, your appliance will be warranted for the remaining term of the original unit's warranty period.

IF EXTENDED WARRANTY WAS PURCHASED FOURTH THROUGH FIFTH YEAR LIMITED EXTENDED WARRANTY (CERTAIN COMPONENT PARTS ONLY - LABOR NOT INCLUDED)

In the fourth through fifth years from the date of original purchase, when this major appliance is installed, operated and maintained according to instructions attached to or furnished with the product, Invisacook will pay for factory specified parts for the following components to correct non-cosmetic defects in materials or workmanship in these parts that prevent function of this major appliance and that existed when this major appliance was purchased. This is a limited 2-year extension warranty on the below named parts only and does not include repair labor.

- Electric element
- Induction Coils
- Solid state touch control system parts

YOUR SOLE AND EXCLUSIVE REMEDY UNDER THIS LIMITED WARRANTY SHALL BE PRODUCT REPAIR AS PROVIDED HEREIN.

Service must be provided by an Invisacook designated service company. This limited warranty is valid only in the United States or Canada and applies only when the major appliance is used in the country in which it was purchased. This limited warranty is effective from the date of original consumer purchase. Proof of original purchase date is required to obtain service under this limited warranty, and must be registered on the invisacook.com website.

WHAT IS NOT COVERED

1. Commercial, non-residential or multiple-family use, or use inconsistent with published user, operator or installation instructions.
2. In-home instruction on how to use your product.
3. Service to correct improper product maintenance or installation, installation not in accordance with electrical or plumbing codes or correction of household electrical or plumbing (i.e. house wiring, fuses or water inlet hoses).
4. Consumable parts (i.e. light bulbs, batteries, air or water filters, etc.).
5. Defects or damage caused by the use of non-genuine Invisacook parts or accessories.
6. Repairs to parts or systems to correct product damage or defects caused by unauthorized service, alteration or modification of the appliance.
7. Cosmetic damage including scratches, dents, chips, and other damage to appliance finishes unless such damage results from defects in materials and workmanship and is reported to Invisacook within 30 days.
8. Discoloration, rust or oxidation of surfaces resulting from caustic or corrosive environments including but not limited to high salt concentrations, high moisture or humidity or exposure to
9. Food loss due to product failure.
10. Pick-up or delivery. This product is intended for in-home repair.
11. Travel or transportation expenses for service in remote locations where an authorized INVISACOOK servicer is not available.
12. Removal or reinstallation of inaccessible appliances or built-in fixtures (i.e. trim, decorative panels, flooring, cabinetry, islands, countertops, drywall, etc.) that interfere with servicing, removal or replacement of the product.
13. Service or parts for appliances with original model/serial numbers removed, altered or not easily determined.

The cost of repair or replacement under these excluded circumstances shall be borne by the customer.

DISCLAIMER OF IMPLIED WARRANTIES

IMPLIED WARRANTIES, INCLUDING ANY IMPLIED WARRANTY OF MERCHANTABILITY OR IMPLIED WARRANTY OF FITNESS FOR A PARTICULAR PURPOSE, ARE LIMITED TO ONE YEAR OR THE SHORTEST PERIOD ALLOWED BY LAW. Some states and provinces do not allow limitations on the duration of implied warranties of merchantability or fitness, so this limitation may not apply to you. This warranty gives you specific legal rights, and you also may have other rights that vary from state to state or province to province.

DISCLAIMER OF REPRESENTATIONS OUTSIDE OF WARRANTY

Invisacook makes no representations about the quality, durability, or need for service or repair of this major appliance other than the representations contained in this warranty. If you want a longer or more comprehensive warranty than the limited warranty that comes with this major appliance, you should Apply for this extension at the registration or your unit or your retailer about buying an extended warranty.

LIMITATION OF REMEDIES; EXCLUSION OF INCIDENTAL AND CONSEQUENTIAL DAMAGES

YOUR SOLE AND EXCLUSIVE REMEDY UNDER THIS LIMITED WARRANTY SHALL BE PRODUCT REPAIR AS PROVIDED HEREIN INVISACOOK SHALL NOT BE LIABLE FOR INCIDENTAL OR CONSEQUENTIAL DAMAGES. Some states and provinces do not allow the exclusion or limitation of incidental or consequential damages, so these limitations and exclusions may not apply to you. This warranty gives you specific legal rights, and you also may have other rights that vary from state to state or province to province.



Natural Stone Disclosure form with the Invisacook

Invisacook Inc. does not guarantee the performance of Natural Stone as of Granite,. Your product warranty does not cover replacements, corrections, or any results of misuse, including, but not limited to, improper maintenance or normal wear and tear. Your product warranty is on the Invisacook product itself and the cost for replacing the Invisacook product. This warranty does not cover any variations in colors, markings or inconsistency of the Stone material once the customer has approved the material for fabrication. This warranty covers installation only, and in no way, provides a warranty against scratches or staining by human error, pitting/ fissures (natural occurrences) or etching in the material.

NATURAL STONE IS A PRODUCT OF NATURE AND IS THEREFORE SUBJECT TO ALL ITS INHERENT VARIATIONS. CAST VEINING, MARKINGS AND COLORATION OF THE FINAL PRODUCT MAY VARY. THE SLABS ARRIVE TO THE FABRICATION LOCATION WITH THE FACE ALREADY FINISHED AND NATURAL STONE MAY HAVE SMALL PITS OR MARKS OR IRREGULARITIES IN TEXTURE OR SHINE THEREFORE IT IS IMPORTANT TO VIEW AND APPROVE THE SLAB BEFORE FABRICATION WHENEVER POSSIBLE.

PERFORMANCE: Every natural stone will perform different depending on the makings of that stone. Stone that might possibly have iron within the stone, can sometimes not work, due to it reflecting the frequency. Invisacook will not guarantee the performance of the Invisacook unit when granite is being used, that is milled to 1.5cm in the area of the cooktop.

STAINING: Discoloration of the marble or granite, whether general or localized, is staining. Staining may be the result of exposure to a variety of exterior substances, or to internal occlusions in the stone or structural elements.

Some of the most common types of staining and the causative agents are:

1. Oil / grease stains
2. Dyes and inks
3. Organic stains: Organic stains are caused by direct contact with decomposing organic matter, such as leaves, flowers, tea, or coffee.
4. Metallic stains: Two major categories of metallic staining are based on either iron or copper.
5. General dirt, soot and pollution
6. Surface Temperatures that can reach over 300 degrees, not through the use of an

approved heat resistant Mat, APPROVED by Invisacook Inc, AND NOT used for cooking anything above this temperature, is excluded from the Warranty of the Invisacook product.

CRUMBLING: This condition is due to a certain brittleness or tendency of the stone to break up or dissolve. It may be caused by an inherent weakness in the stone or gradual breakdown of the binder or crystalline structure, or it may be the result of external factors affecting the strength and durability of the marble.

CHIPPING: The separation of small pieces or larger fragments, frequently at the corners or edges is known as chipping. These fractures are generally caused by deterioration, by accident, or vandalism.

CRACKING: This condition is manifested by the appearance of narrow fissures ranging from less than 1/16 to 1/2-inch-wide or more in the stone. It results from a variety of causes, such as structural overloading due to settlement or a flaw in the material. Minor cracking may be no problem, in and of itself, but it can be an indication of structural problems and the cracks can be a source of entry of water into the interior of the stone.

BRUISING: This is the appearance of white spots on the Marble & Granite, which can be caused by an object being dropped or some other force against the stone. Even the slightest mishap could potentially cause bruising due to the soft nature of the stone. The stone will be sealed at/by the time of install by your fabricator and make sure they have done so. This will help, but not prevent staining. Marble and Granite need to be regularly maintained and sealed.

I HAVE READ THE FOLLOWING DISCLOSURE AND HEREBY UNDERSTAND THE LIABILITY WITH THE WARRANTY AND THAT THE INVISACOOK PRODUCT AND COUNTERTOP SURFACE ARE DIFFERENT AND SEPARATE IDENTITIES TO THE ENTIRE WARRANTY. NO SIGNATURE AND CONTINUED PURCHASE OF AN INVISACOOK UNIT WILL IMPLY AGREEMENT TO THE ABOVE TERMS AND CONDITIONS.

Name (print): _____ Date: _____

Signature: _____